

**Architectural project**

**Kindergarten**

**Laghidze street,  
Zugdidi**





TABLE OF CONTENT

Title page	1
Table of Contents, Explanatory Letter	2
Render	3
Cadastral data	4
Cadastral data	5
Photos of the existing area	6
Layout Plan on Orthophoto	7
Compliance analysis with building safety rules	8
Load of occupation, access and exits	9
Topographic plan	10
Layout Plan	11
Territory marking off	12
General plan	13
Vertical planning	14
Fence, gate and walkway	15
Floor plan	16
Facades	17
Facades	18
Textures on render	19
Sections	20
Types of floors and windows	21
Doors and windows	22
Toilet partitions	23
Technological scheme of storage	24
Roof plan	25
Project of organizing the construction	26
General Construction Plan	27
Time-schedule of construction	28

Explanatory Letter  
General Information

Construction site (cadastre code 43.31.69.416) is located in Zugdidi. According to the norms "Construction Climatology" the climatic characteristics of the construction site are:

- Average annual temperature + 13.8 ° C
- Absolute maximum temperature + 40 ° C
- Absolute minimum temperature - 19 ° C
- Annual rainfall - 1723 mm
- Snow cover weight - 0.5 kPa
- Standard height of seasonal ground frost - 0 m
- Standard pressure of the wind is 0.3 kPa
- The direction of the prevailing wind is - East
- According to the map of seismic zones, Zugdidi belongs to the 8-point seismic zone.

From the geological point of view of engineering, the construction site is in satisfactory condition, physical-geological events (landslides, hailstones, etc.) are not observed.

Planning

The construction site is a rectangular plot of land bounded by the public zone from the north and south, namely the streets, and adjacent land plots on all sides.

There are no solid buildings in the area.

The project envisages the placement of a kindergarten building by the main facade to the south, to the street side, with main entrances to the west and south. The development and landscaping of the yard and arrangement of a playground and a harbor are planned as well as fencing.

The planning solution of the building includes the placement of three groups of kindergarten. Two of them will have a bedroom unit, while such a unit will not be for preschoolers; the girls 'and boys' toilets in this group are separated.

The building

The building represented in the project is a one-storey stone building the floor level of which is elevated by an average of 1.0 meters from the ground floor (including the walkway). The first floor marker 0.00 corresponds to absolute marker 106.0.

The floor height of the building is 3.4 meters from floor to ceiling. Exterior walls are made of reinforced concrete a small wall pumice block of 30 cm thickness.

The bearing structure of the building is a complex reinforced concrete frame, made of reinforced concrete pillars, monolithic reinforced concrete girds, and reinforced concrete roofing slabs. Partitions are made of reinforced small pumice block of 10 cm thickness. The floors in the bathrooms are tiled, and the floors in the rooms are wooden (deck planks). Heat insulation of floor is made of XPS tiles, and ceiling insulation is made with fibered glass. Suspended ceilings in the kitchen and bathroom units are made of plastic and in the rooms are made of gypsum boards.

Technical indicators for the area:

The total area of the territory - 4480.0 m2  
Development area - 769.7 m2  
Development density - 769.7 m2  
Planting area - 3190.0 m2  
The coefficient k 1 - 0.2  
The coefficient k 2 - 0.2  
Coefficient K 3 - 0.7

Technical specifications of the building:

Number of the floors of the building – 1  
The volume of the building - 5313.0 m3  
Including the surface of the land - 4158.0 m3  
Underground - 1155.0 m3  
Total area - 709.2 m2



Danish Refugee  
Council

Kindergarten  
Laghidze  
street, Zugdidi

კ-1-ს ეროვნული

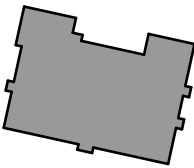

769.7 m2

Project address:  
Georgia,  
Zugdidi

Stage:  
Architectural project

Explanatory  
note

ბ. ჯანთარია  
B. Qantaria

ა. გერგელავა  
A. Gergedava

ფორმატი  
Format A - 2

ფურცელი Page	ფურცლები Pages
2	28

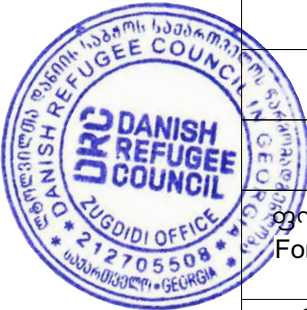



Rendering



**Kindergarten**  
**Laghidze**  
**street, Zugdidi**

Project address:  
Georgia,  
Zugdidi

Stage:  
Architectural project

Render  
**Rendering**

ბ. ქანთარია  
B. Qantaria

ა. გერგელავა  
A. Gergedava

ფორმატი  
Format A - 2

ფურცელი  
Page 3

ფურცლები  
Pages 28





"ფიზიკური პირის მიერ 2 წლამდე ვადით საკუთრებაში არსებული მატერიალური აქტივის რეალიზაციისას, აგრეთვე საგაღისასადო წლის განმავლობაში 1000 ლარის ან მეტი ღირებულების ქონების სანუქრად მიღებისას საშემოსავლო გადასახადი გადახდის ექვემდებარება საინგარიშო წლის მომდევნო წლის 1 აპრილამდე, რის შესახებაც აღნიშნული ფიზიკური პირი იმავე ვადაში წარუდგენს ლეკლარაციის საგაღისასადო ორგანოს. აღნიშნული ვალდებულების შეუსრულებლობა წარმოადგენს საგაღისასადო სამართალდარღვევას, რაც იწვევს პასუხისმგებლობას საქართველოს საგაღისასადო კოლექსის XVIII თავის მსჯელობით."

- ლოკუმენტის ნაშლილობის გადამოწმება შესაძლებელია საჯარო რეესტრის ეროვნული სააგენტოს ოფიციალურ ვებ-გვერდზე [www.napr.gov.ge](http://www.napr.gov.ge);
- ამონაწერის მიღება შესაძლებელია ვებ-გვერდზე [www.napr.gov.ge](http://www.napr.gov.ge), ნებისმიერ გერიაგორიულ სარეგისტრაციო სამსახურში, იუსტიციის სახლებსა და სააგენტოს აგეგორირებულ პირუთიან;
- ამონაწერში გვენიკური სარგეშის აღმოჩენის შემთხვევაში ღაგეიკაგეშირლით: 2 405405 ან პირაღლ შეფესეი განაცხადი ვებ-გვერდზე;
- კონსულტაციის მიღება შესაძლებელია იუსტიციის სახლის ცხელ ხაზზე 2 405405;
- საჯარო რეესტრის თანამშრომელთა მსიღის უკანონო ქმედების შემთხვევაში ღაგეიკაგეშირლით ცხელ ხაზზე: 08 009 009 09
- თქვენივის საინგეტრესო ნებისმიერ საკითხთან ღაკაგეშირებით მოგვეწერეთ ელ-ფოსტით: [info@napr.gov.ge](mailto:info@napr.gov.ge)

მიწის (უძრავი ქონების) საკაღისტრო კოდი: **N 43.31.69.416**

ამონაწერი საჯარო რეესტრიღან

განცხადების რეგისტრაცია

მომზადების თარიღი

N 882019638676 - 06/08/2019 14:31:43

08/08/2019 13:38:29

საკუთრების განყოფილება

ზონა	სექტორი	კვარტალი	ნაკვეთი	ნაკვეთის საკუთრების ტიპი:საკუთრება
ზუგდიდი	ქ. ზუგდიდი			ნაკვეთის დანიშნულება: არასასოფლო სამეურნეო
<b>43</b>	<b>31</b>	<b>69</b>	<b>416</b>	დამუშგებული ფართობი: 4480.00 კვ.მ.

მისამართი: ქალაქი ზუგდიდი, რ. ლაღიღის შესახვევი N2ა

ნაკვეთის წინა ნომერი:

მესაკუთრის განყოფილება

განცხადების რეგისტრაცია : ნომერი 882019638676 , თარიღი 06/08/2019 14:31:43

უფლების რეგისტრაცია: თარიღი 08/08/2019

უფლების დამაღასტრებული ღოკუმენტი:

- ბრძანება N1/1-1709 , დამოწმების თარიღი:26/06/2019 ,სსიპ სახელმწიფო ქონების ეროვნული სააგენტო

მესაკუთრები:

სსიპ ზუგდიღის მუნიციპალიტეტი, ID ნომერი:220418956

მესაკუთრე:

ალწერა:

სსიპ ზუგდიღის მუნიციპალიტეტი

იპოთეკა

საგაღისასადო გირავნობა:

რეგისტრირებული არ არის

ვალდებულება

ყაღაღა/აკრძალეა:

რეგისტრირებული არ არის

მოვალეთა რეესტრი:

რეგისტრირებული არ არის

საჯარო რეესტრის ეროვნული სააგენტო. <http://public.reestri.gov.ge>

გვერდი: 1(2)

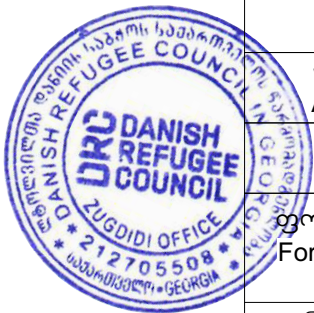





საკადასტრო გეგმა

საქართველოს რეესტრის ეროვნული  
სააგენტო

საკადასტრო კოდი: **43.31.69.416**  
განცხადების ნომერი: **882019493500**  
მომზადების თარიღი: **23/06/2019**

ნაკვეთის დანიშნულება:  
ფართობი:

არასასოფლო საშენობო  
**4481 კვ.მ (WGS 84 / UTM zone 38N)**  
**4480 კვ.მ (WGS 84 / UTM zone 37N)**

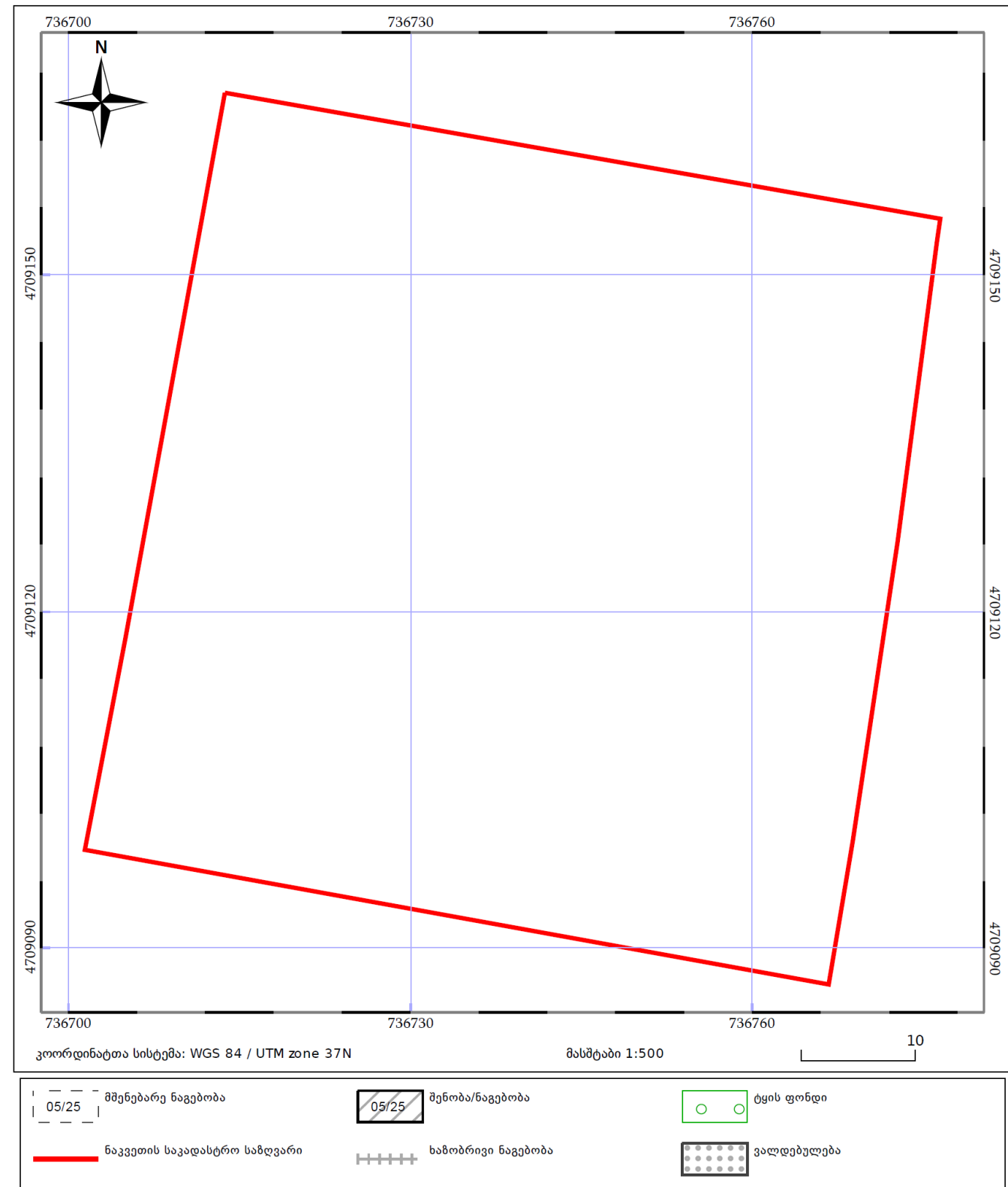

საქართველოს რეესტრის ეროვნული სააგენტო: ქალაქი თბილისი, სანაპიროს ქუჩა, N2; ტელ: (995 32) 2 25 15 28;

<http://napr.gov.ge>







**Kindergarten  
Laghidze  
street, Zugdidi**

Project address:  
Georgia,  
Zugdidi

Stage:  
Architectural project

**Photos of the  
Territory**

ბ. ქანთარია  
B. Qantaria

ა. გერგელავა  
A. Gergedava

ა. გერგელავა

ფორმატი  
Format A - 2

ფურცელი  
Page

ფურცლები  
Pages

6

28

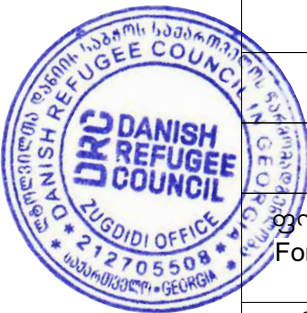





**Kindergarten  
Laghidze  
street, Zugdidi**

Project address:  
Georgia,  
Zugdidi

Stage:  
Architectural project

**Layout Plan**

ბ. ქანთარია  
B. Qantaria

ა. გერგელავა  
A. Gergedava

ფორმატი  
Format A - 2





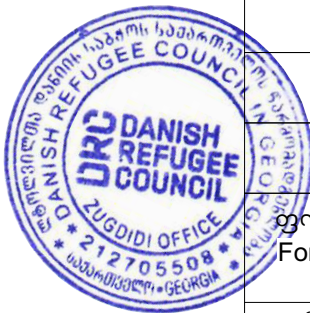





ფურცელი  
Page 7

ფურცლები  
Pages 28





Conventional Signs

	Cadastral border
	Wall fireproof (one hour)
	Wall Fireproof (150 minutes)
	Educational Group EG
	Concrete block arrangement
	Business Group BG
	Gathering Group GG-2
	Gathering Group GG-3
	Warehouse Group-2
	Hand fire extinguisher

Compliance analysis of the building with safety rules

Used rules- Building Safety Rules
-----------------------------------

List the occupations of the building
Educational Group EG
Business Group BG
Gathering Group-2
Gathering Group- GG-3
Warehouse Group SG-2

Structure Type		
Determine the construction type for the new building	V -	
Height Limitations		
Occupations	Allowable Height	Suggested Height
1. Educational Group EG	1 Floor	1 Floor
2. Business groupd BG	2 Floor	
3. Gathering Group GG-2	1 Floor	
4. Gathering Group -3	1 Floor	
5. Warehouse Group	2 Floor	
Total Height	12.2	8.00
Number of floors above ground		1 Floor

Limitations of the Area			
Occupations	Allowable area	Suggested Area	
1. Educational Group EG	880	173.21 m <sup>2</sup>	
2. Business groupd BG	840	25.2 m <sup>2</sup>	
3. Gathering Group GG-2	560	168.33 m <sup>2</sup>	
4. Gathering Group -3	560	74.34 m <sup>2</sup>	
5. Warehouse Group	1250	81.1 m <sup>2</sup>	
Total Area of The Flooring	709.21 m <sup>2</sup>		
Quantity of Flooring	Aboe the ground level 1		
Total area of the building	747.45 m <sup>2</sup>		

Requirements to External Wall Aperture					
External Wall	Fire-fighting distance	Area of the Wall Aperture			
		Allowable		Envisaged	
		Protected	Unprotected	Protected	Unprotected
Axis 1-12	11 m.	unlimited	unlimited		28 %
Axis A-F	22 m.	unlimited	unlimited		16 %
Axis 12-1	33 m.	unlimited	unlimited		20 %
Axis F-A	10 m.	unlimited	unlimited		20 %

Requirements to the Fire-Prevention System		
Is there an auto-sprinkler system?		No
Is there a fire extinguishing system?		No
Is there a smoke control system?		No
Are there hand-held fire extinguishers?	Yes	
Is there a fire alarm system?	Yes	
Installation of emergency lighting	Yes	

Number and width of exits for Educational					
Floors	Number of exits		Width of exits		
			Stairs		Other components
	Requested	Envisaged	Requested	Envisaged	Requested      Envisaged
I Floor	1	1			0.82      1.00

Number and width of exits and    for Business Group					
Floors	Number of exits		Width of exits		
			Stairs		Other components
	Requested	Envisaged	Requested	Envisaged	Requested      Envisaged
I Floor	1	1			0.82      0.90

Number and width of exits and    for Gathering Group-2					
Floors	Number of exits		Width of exits		
			Stairs		Other components
	Requested	Envisaged	Requested	Envisaged	Requested      Envisaged
I Floor	1	1			0.82      1.00

Number and width of exits for Gathering Group-3					
Floors	Number of exits		Width of exits		
			Stairs		Other components
	Requested	Envisaged	Requested	Envisaged	Requested      Envisaged
I Floor	1	2			0.82      1.50

Number and width of exits for Wharehouse Group-2					
Floors	Number of exits		gasasvlelis sigane		
			Stairs		Other components
	Requested	Envisaged	Requested	Envisaged	Requested      Envisaged
I Floor	1	1			0.82      1.00

Number of fixtures of water supply systems						
Calculation of load of occupation						
Fixtures		Requested			Envisaged	
		I	II	III	I	II      III
Toilet bowl		12			14	
Toilet wahs basin		12			16	
Bathroom/shower room		2			3	
Fountian for drinking water		-			-	
Service wash basin		1			9	





**Kindergarten**  
**Laghidze**  
**street, Zugdidi**

Project address:  
Georgia,  
Zugdidi

უცხადი: გეგმა  
პროექტი  
Stage:  
Architectural project

Load of occupation,  
access and exits

ბ. ქანთარია  
B. Qantaria

ა. გერგედავა  
A. Gergedava

ფორმატი  
Format A - 2





Topographic plan

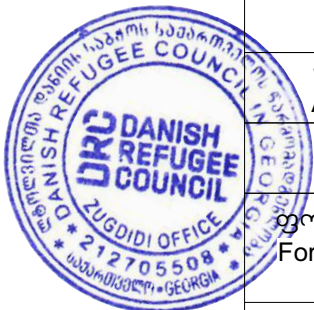
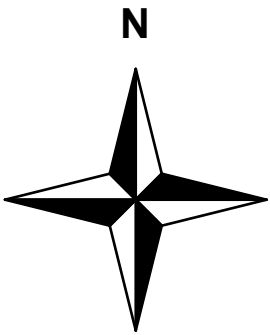



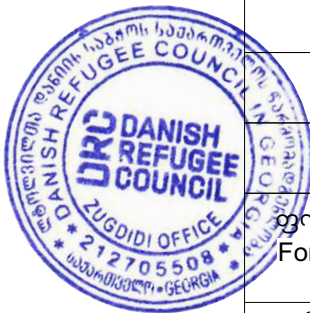
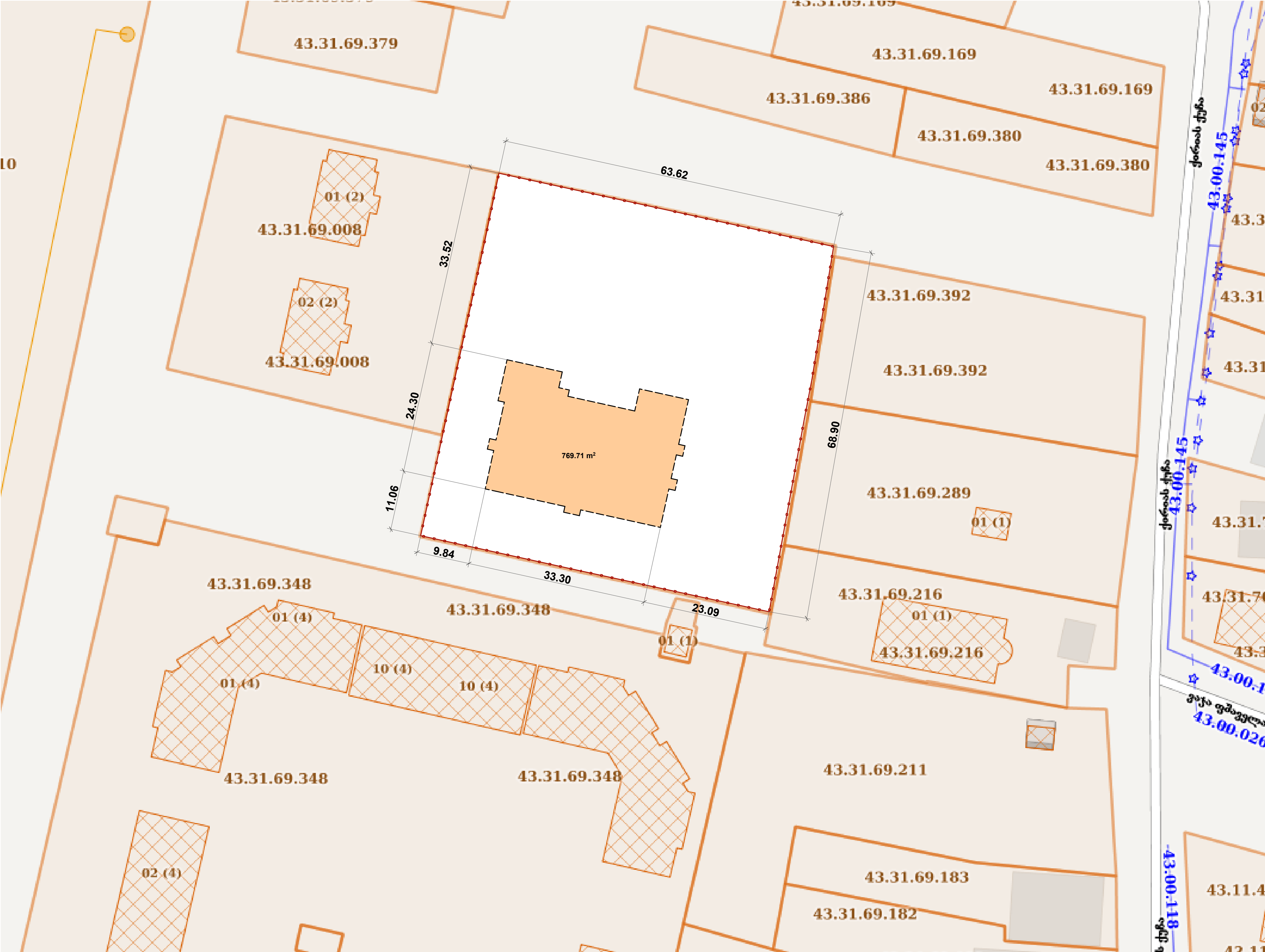



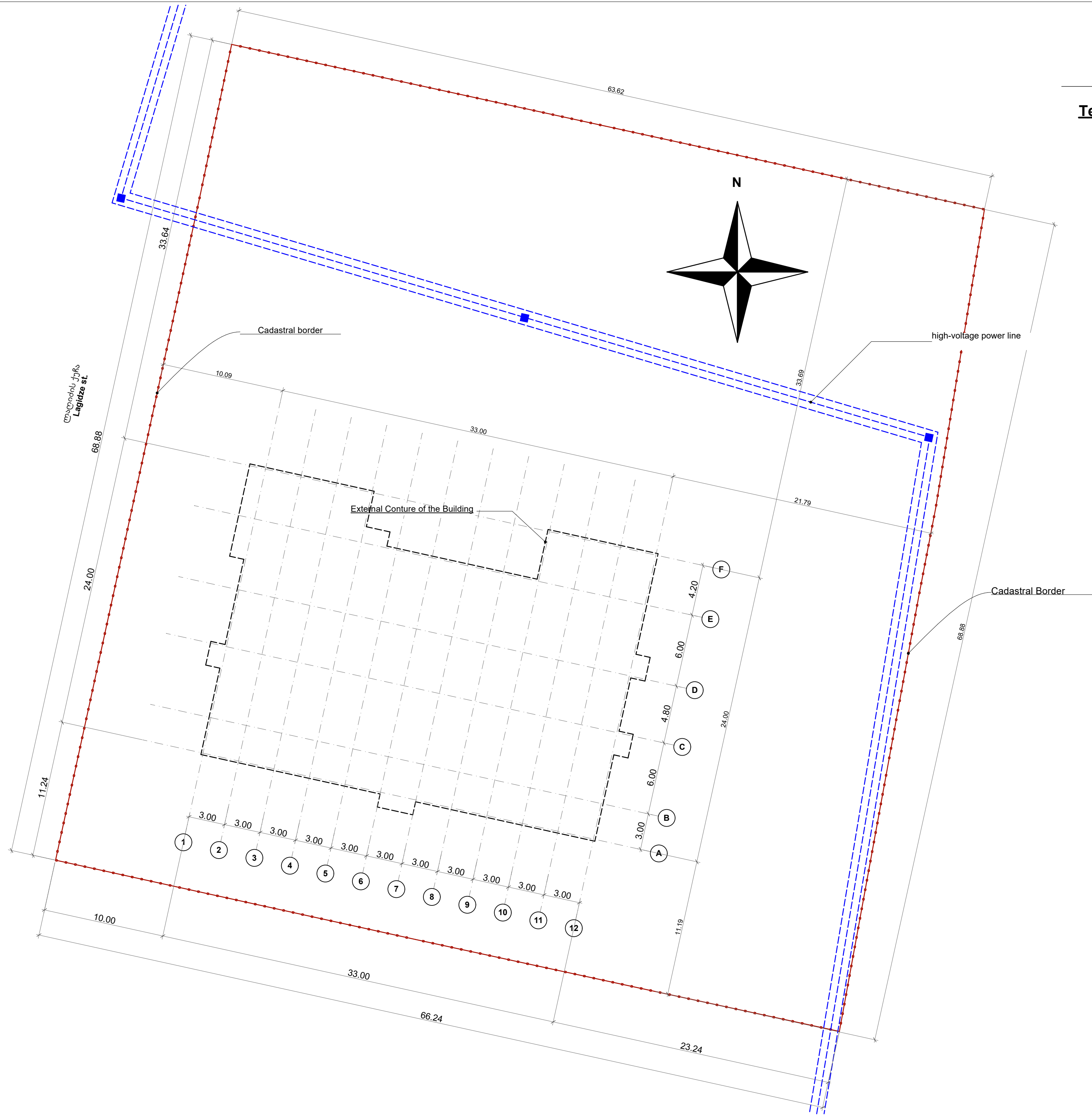

**Territory marking**

Kindergarten  
Laghidze  
street, Zugdidi

Project address:  
Georgia,  
Zugdidi

Stage:  
Architectural project

Territory  
marking

ბ. ქანთარია  
B. Qantaria

ა. გერგელავა  
A. Gergedava

ფორმატი  
Format A - 2

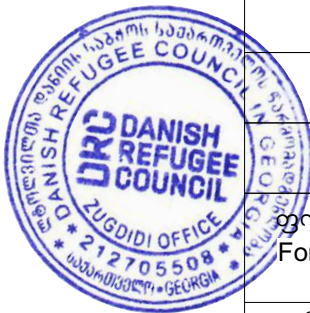



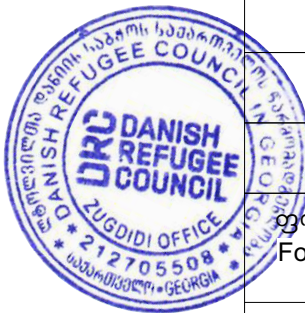
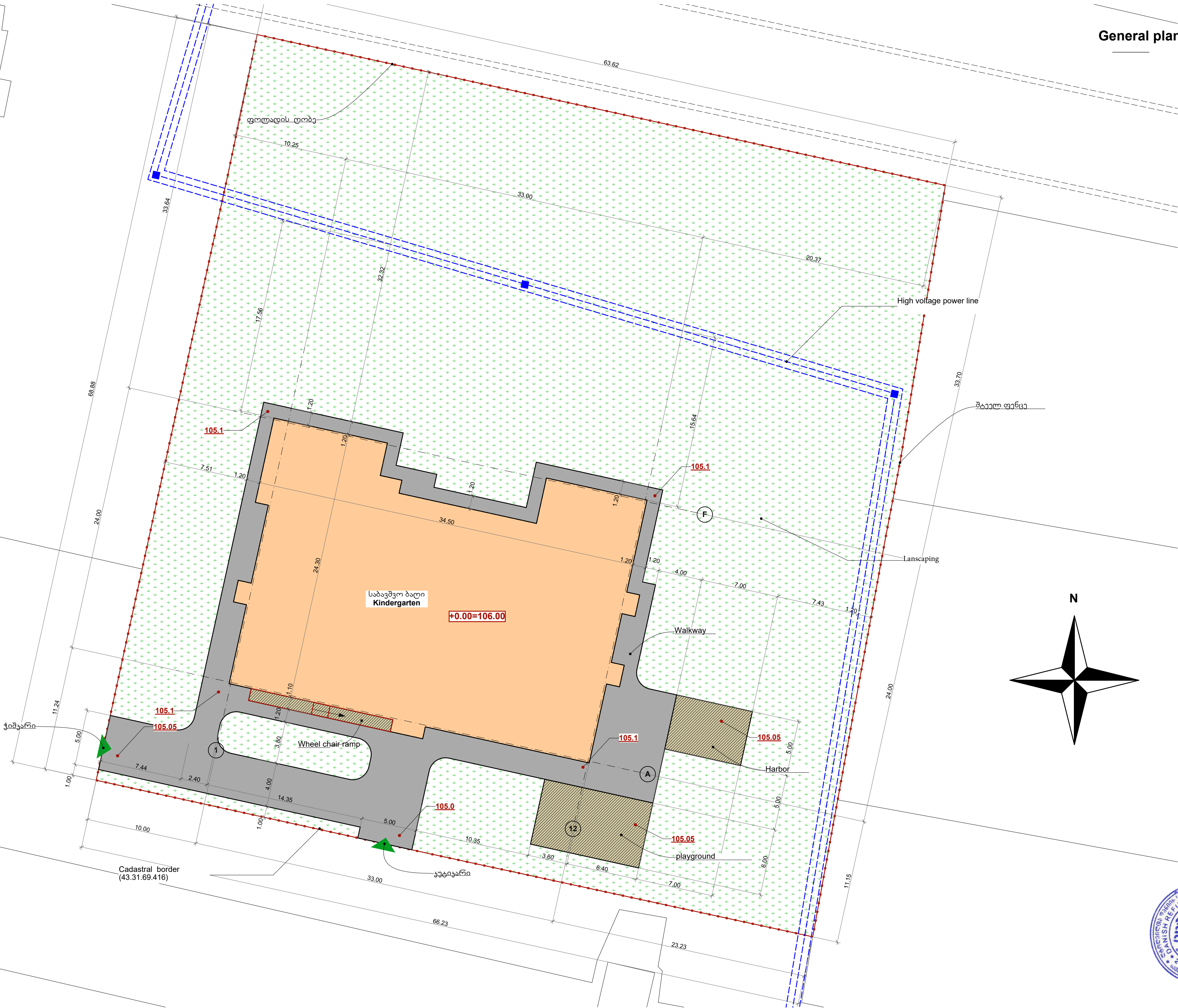
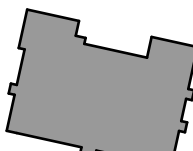







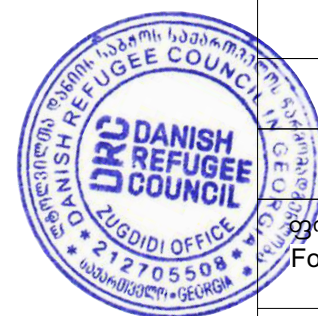
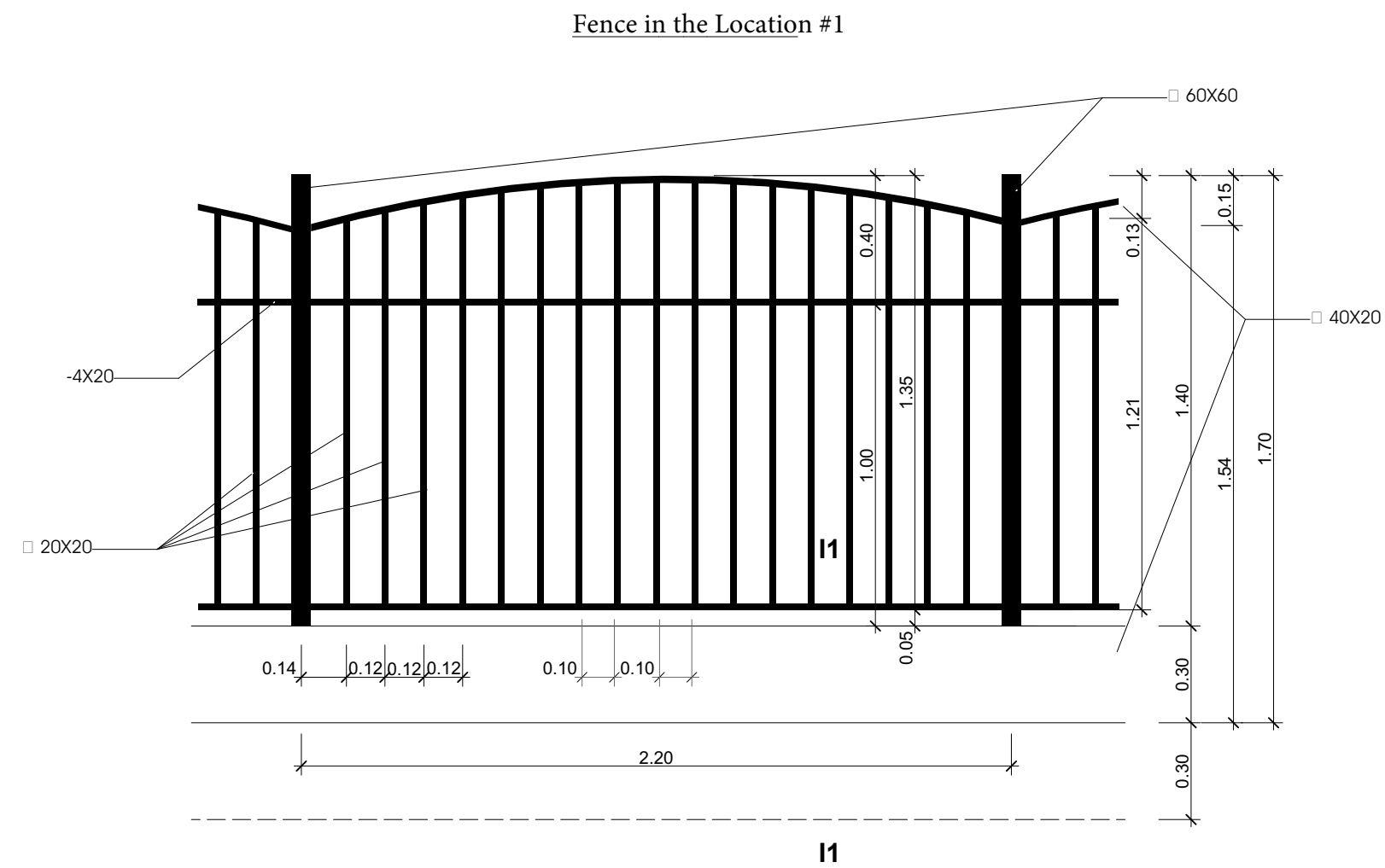
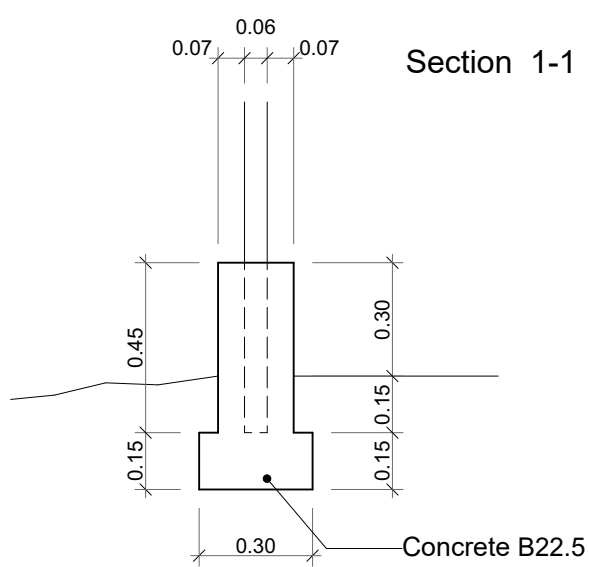
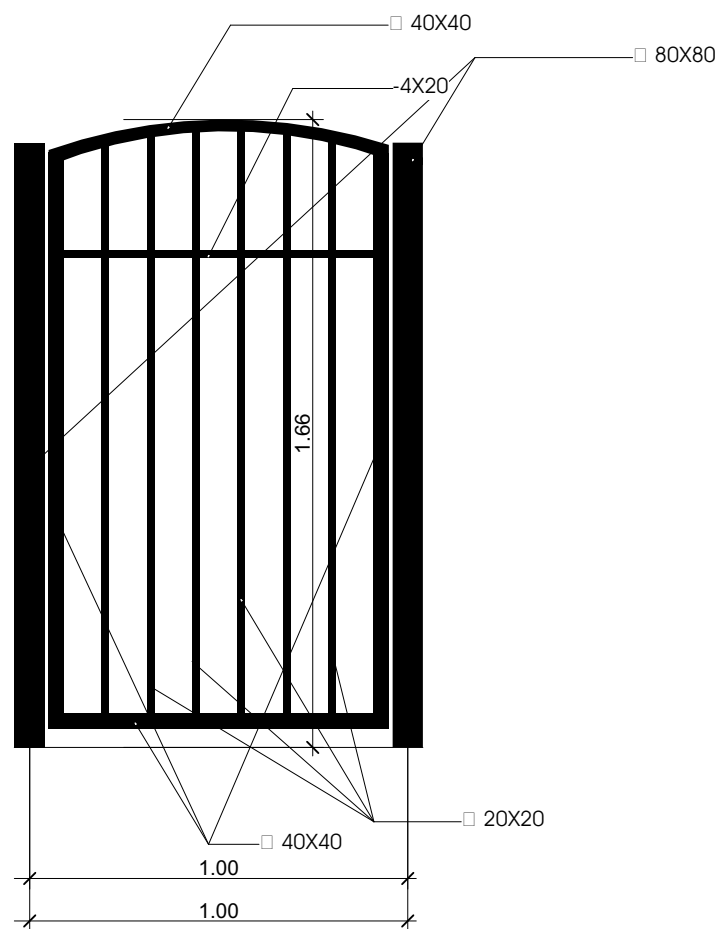
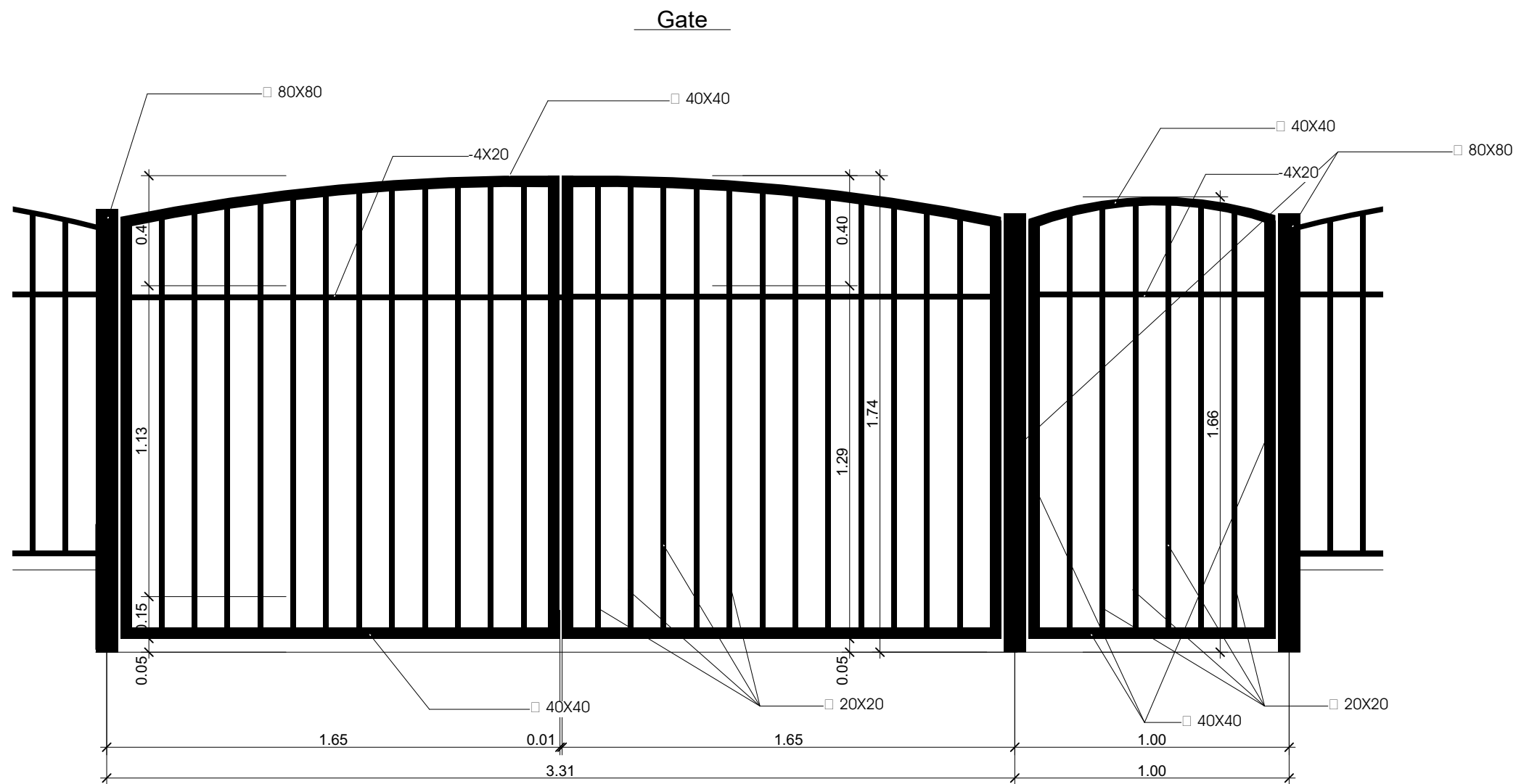
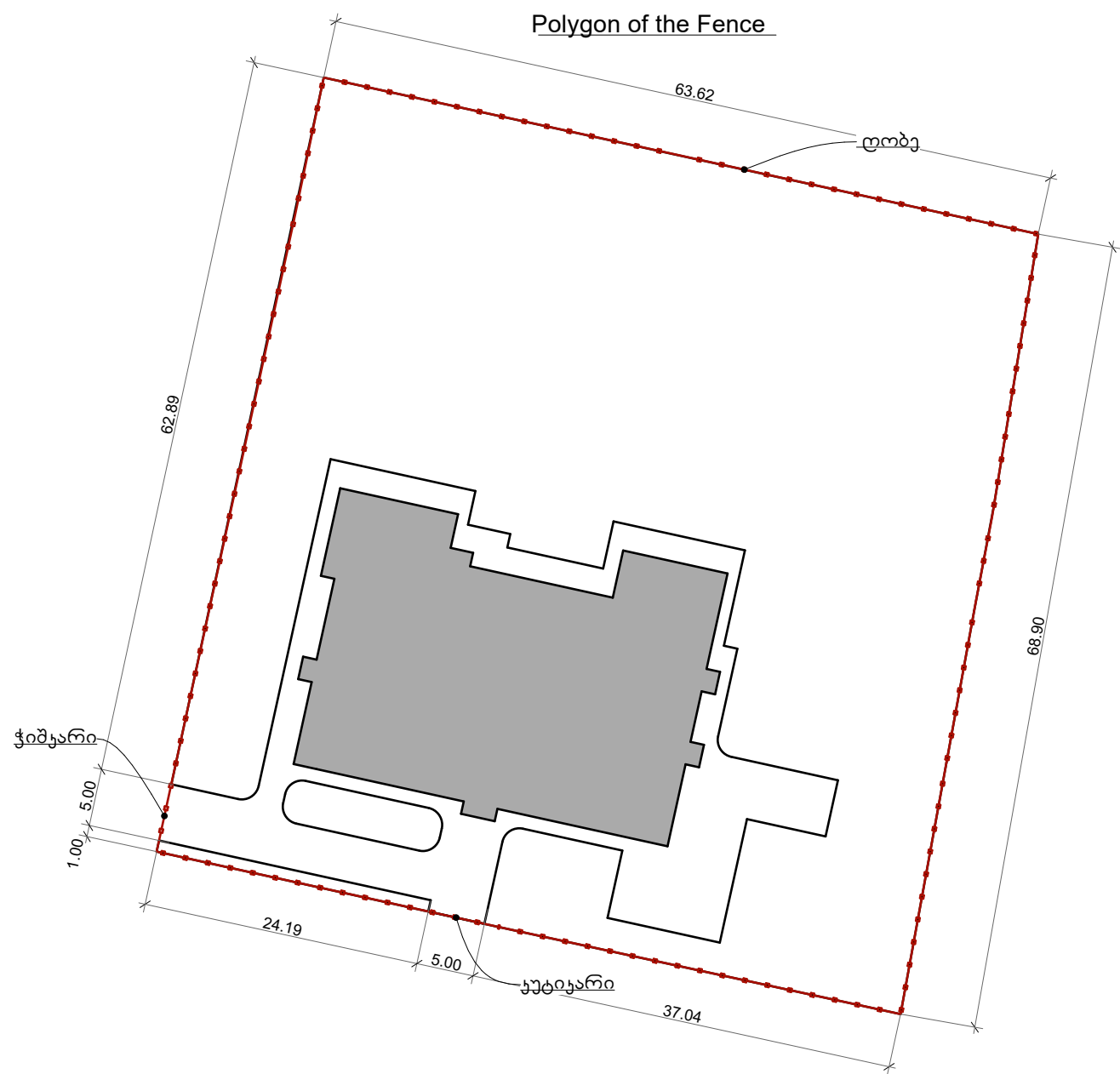



1. ჯგუფის ოთახი	1. Group room	52.51 m <sup>2</sup>
2. საძინებელი	2. Bedroom	51.03 m <sup>2</sup>
3. გასახდელი	3. Wardrobe	17.7 m <sup>2</sup>
4. სანუკანძი	4. WC	15.44 m <sup>2</sup>
5. ბუფეტი	5. Buffet	3.9 m <sup>2</sup>
6. ჯგუფის ოთახი	6. Group room	52.6 m <sup>2</sup>
7. საძინებელი	7. Bedroom	51.03 m <sup>2</sup>
8. გასახდელი	8. Wardrobe	17.7 m <sup>2</sup>
9. სანუკანძი	9. WC	15.6 m <sup>2</sup>
10. ბუფეტი	10. Buffet	3.9 m <sup>2</sup>
11. ჯგუფის ოთახი	11. Group room	49.97 m <sup>2</sup>
12. გასახდელი	12. Wardrobe	18.14 m <sup>2</sup>
13. სანუკანძი ბიჭების	13. WC	5.03 m <sup>2</sup>
14. სანუკანძი გოგონების	14. WC	5.03 m <sup>2</sup>
15. სანუკანძი	15. WC	5.16 m <sup>2</sup>
16. ბუფეტი	16. Canteen	4.02 m <sup>2</sup>
17. სანუკანძი შშმ პირთათვის	17. WC	4.4 m <sup>2</sup>
18. ბაღის დირექტორი	18. Manager	12.6 m <sup>2</sup>
19. მეთოდური კაბინეტი	19. Staff room	10.92 m <sup>2</sup>
20. პერსონალის ოთახი	20. Staff room	7.28 m <sup>2</sup>
21. სანუკანძი	21. WC	2.1 m <sup>2</sup>
22. სანუკანძი	22. Staff room	2.1 m <sup>2</sup>
23. საუკუწაო	23. WC	8.06 m <sup>2</sup>
24. ექიმის ოთახი	24. Doctor's office	12.6 m <sup>2</sup>
25. სანუკანძი	25. WC	2.1 m <sup>2</sup>
26. სანუკანძი	26. WC	2.1 m <sup>2</sup>
27. გასახდელი სანუკანძით	27. Staff wardrobe	7.44 m <sup>2</sup>
28. საკონცერტო დარბაზი	28. Concert hall	74.34 m <sup>2</sup>
29. ჰოლი დერეფნით	29. Hall with corridor	72.59 m <sup>2</sup>
30. დერეფანი	30. Corridor	8.88 m <sup>2</sup>
31. სამზარეულო	31. Kitchen	19 m <sup>2</sup>
32. საუკუების გაყვამის ზონა	32. Distribution room	4.96 m <sup>2</sup>
33. სამზარეულოს სამრეცხაო	33. Washing of kitchen	12.06 m <sup>2</sup>
34. მშრალი პროდუქტის საწყობი	34. Dry food warehouse	3.52 m <sup>2</sup>
35. ბოსტნეულის საწყობი	35. Vegetable warehouse	2.88 m <sup>2</sup>
36. სამრეცხაო-საუთოებელი	36. Washing and Ironing room	11.18 m <sup>2</sup>
37. სუფთა თეთრეთულის საწყობი	37. Clean laundry warehouse	2.8 m <sup>2</sup>
38. დარბაზის ინვენტარის ოთახი	38. Inventory warehouse	4.88 m <sup>2</sup>
39. საქვავებ მუერნობა	39. Boiler room	3.3 m <sup>2</sup>
40. აივანი	40. Balcony	26.1 m <sup>2</sup>
41. კიბის ბაქანი	41. Stairway	3.3 m <sup>2</sup>
42. კიბის ბაქანი	42. Stairway	2.4 m <sup>2</sup>
43. კიბის ბაქანი	43. Stairway	9.36 m <sup>2</sup>
44. კიბის ბაქანი	44. Stairway	2.4 m <sup>2</sup>
45. კიბის ბაქანი	45. Stairway	2.4 m <sup>2</sup>
46. კიბის ბაქანი	46. Stairway	2.4 m <sup>2</sup>
47. პანდუსი	47. Pandus	
საერთო ფართობი	Total area	709.21 m <sup>2</sup>

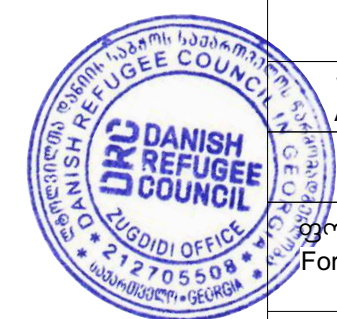



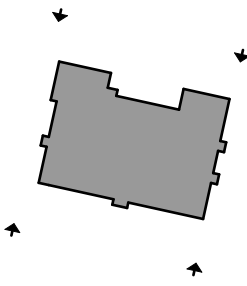

**Facade 1-12**

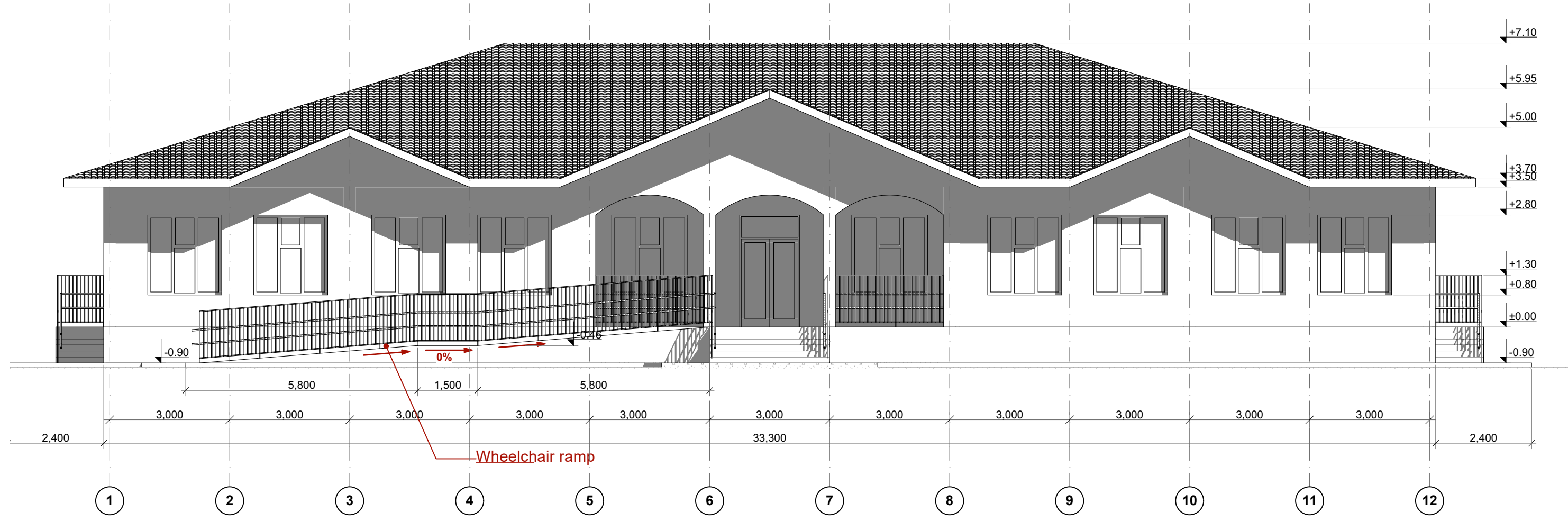

**Facade 12-1**

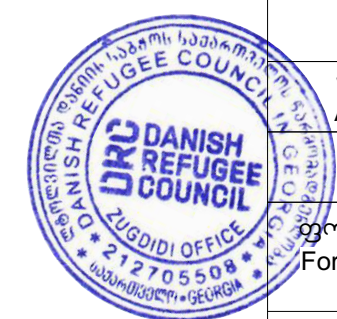
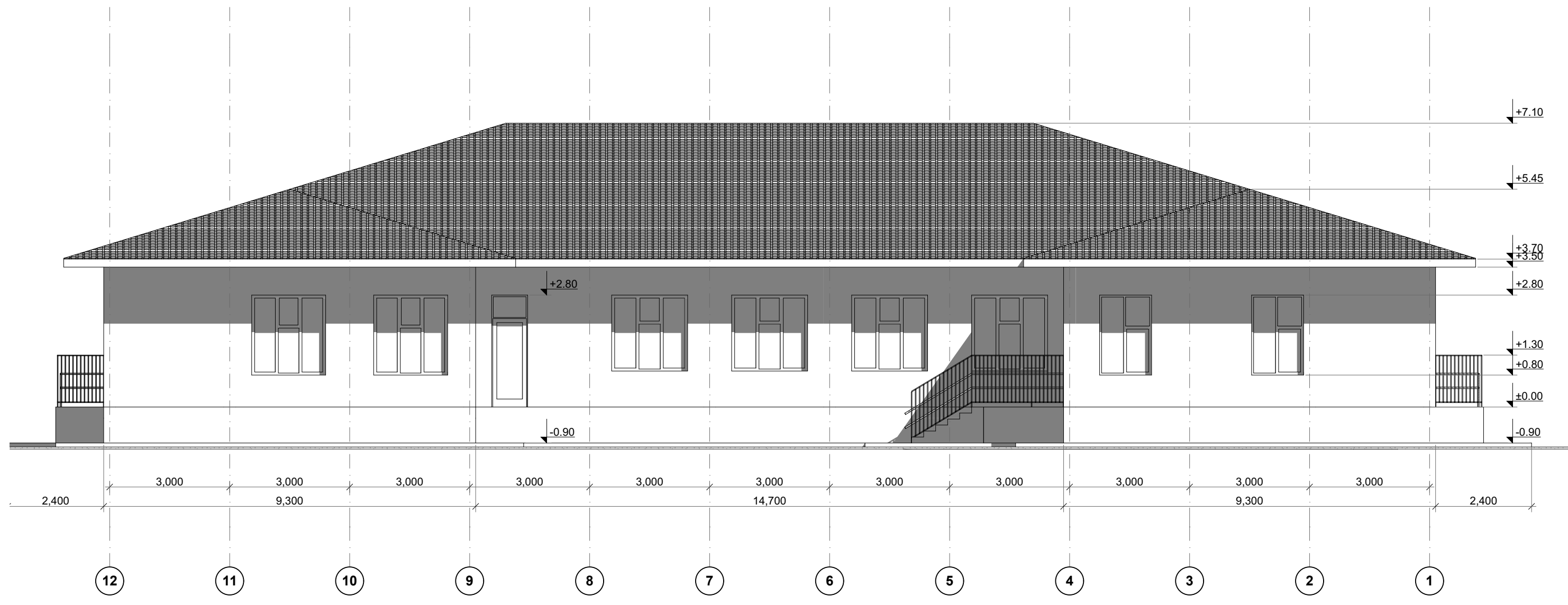



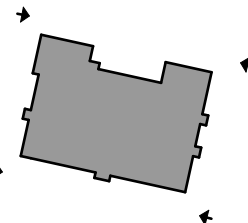

Facade F-A

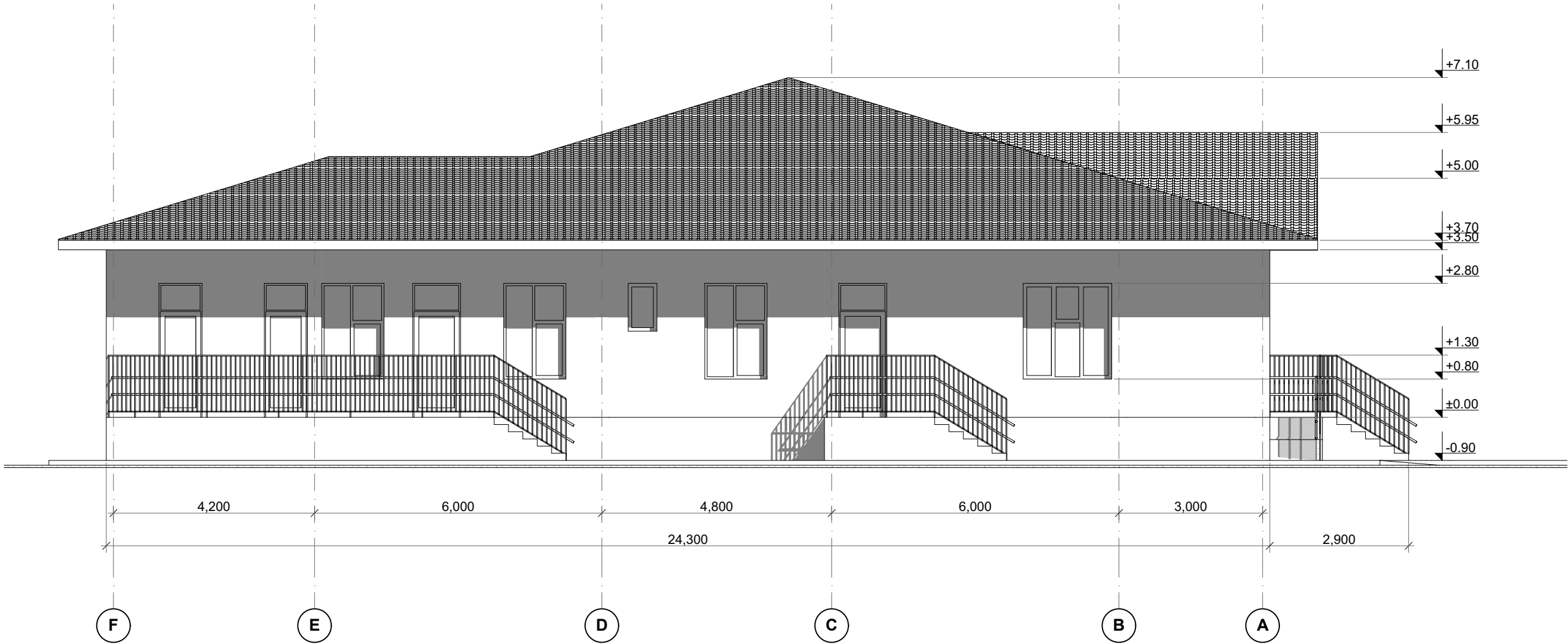

Facade A-F

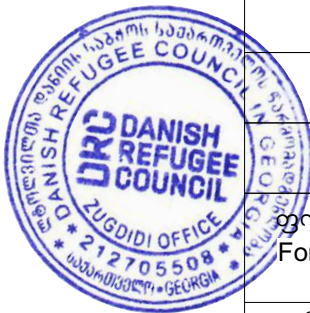



Textures on the Render



PVC Window

Project address:  
Georgia,  
Zugdidi

Stage:  
Architectural project

Textures on  
render

ბ. ჟანთარია  
B. Qantaria

ა. გერგელავა  
A. Gergedava

ფორმატი  
Format A - 2

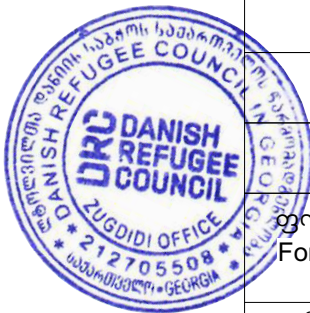



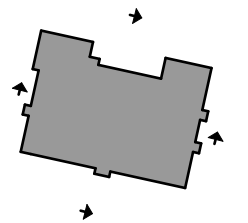

Section A-A

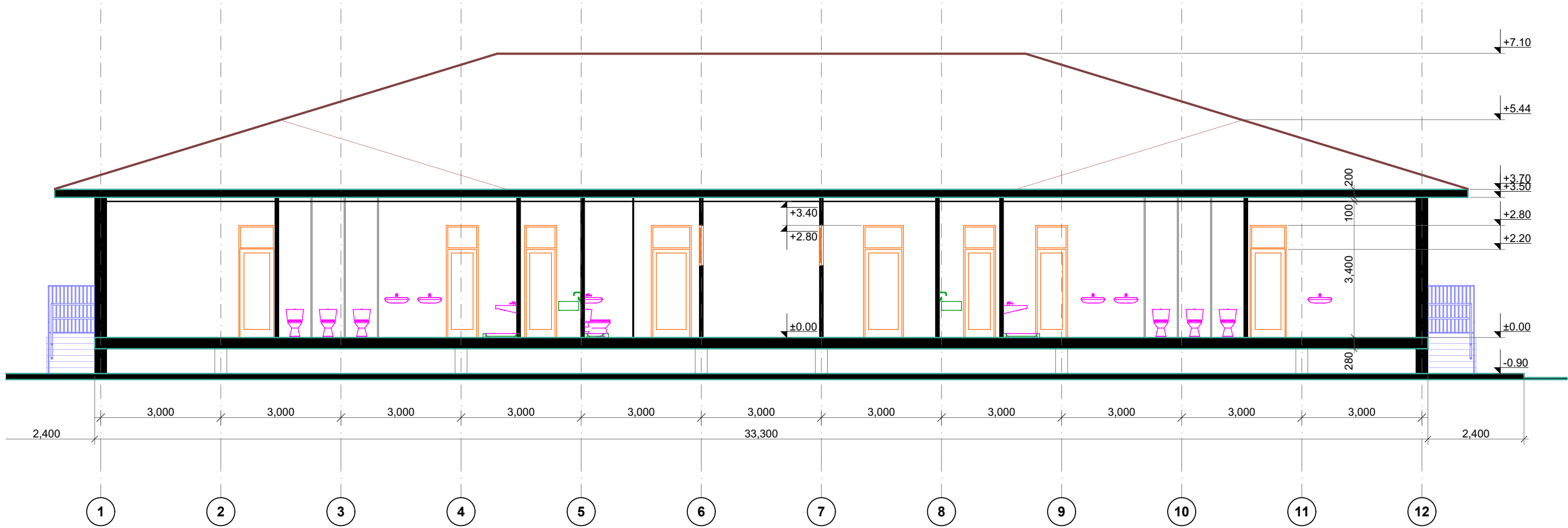

Section B-B

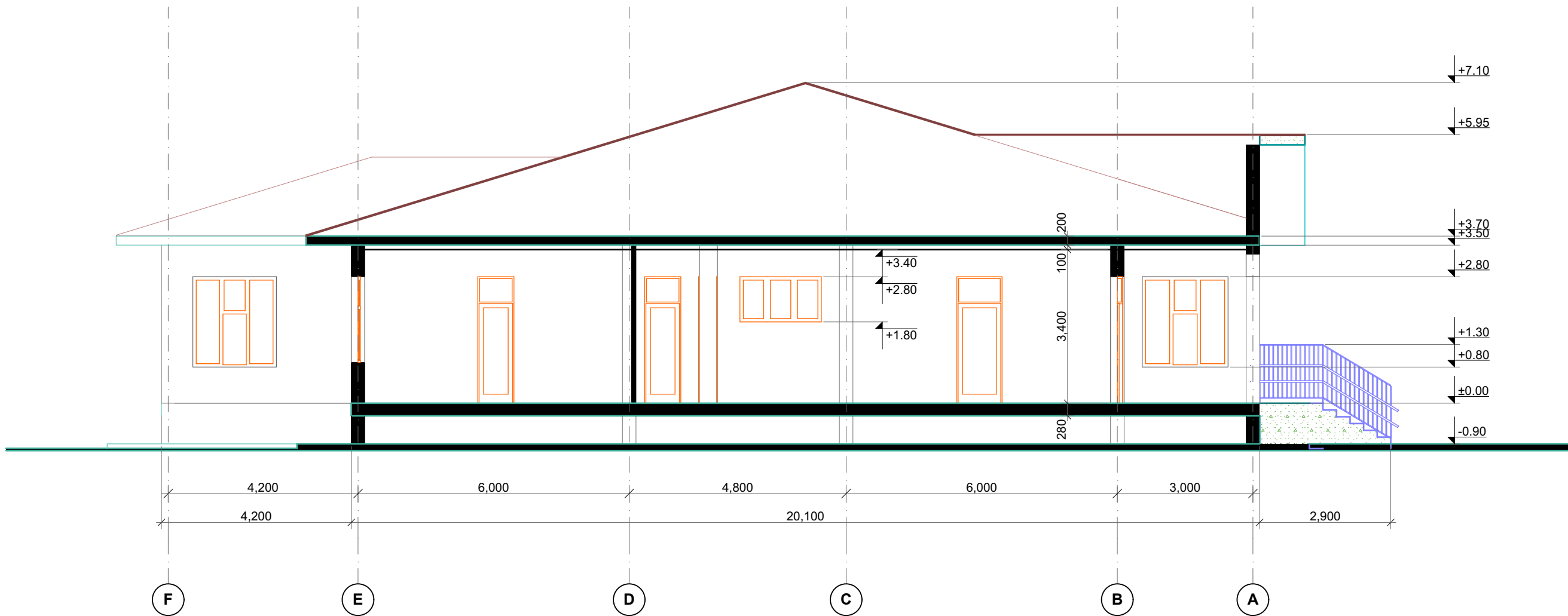



Types of Floors and Doors and Windows on the Plan

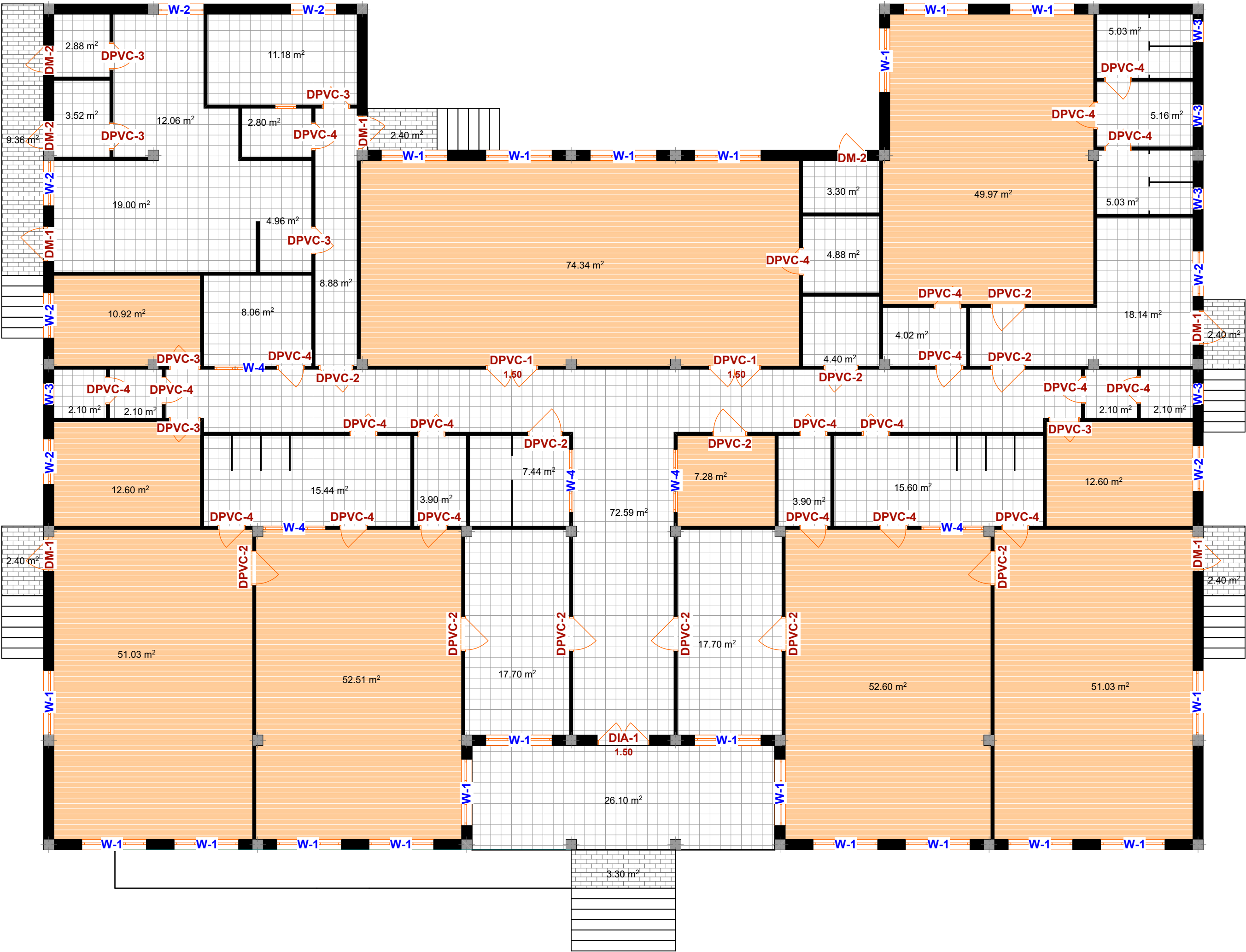

Wooden (deck) floor  
Wooden (deck) floor with a thickness of 27 mm  
Longitudinal beam 40X80 cm  
Regulatory underlayer  
Insulation (between longitudinal) XPS slabs 30 mm  
Reinforced concrete slab with a thickness of 8 cm Polyethylene film with thickness 0.1 mm  
Gravel imbankemnt

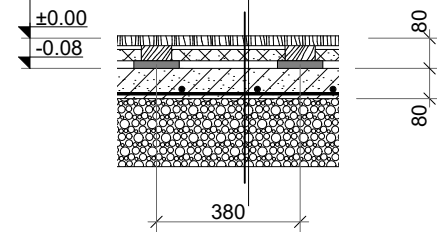

Ceramic (tiled ) floor  
Leveling with cement-sand mortar  
Insulation with XPS slabs 30 mm  
Reinforced concrete slab with a thickness of 8 cm  
Polyethylene film thickness 0.1 mm  
Gravel imbankment

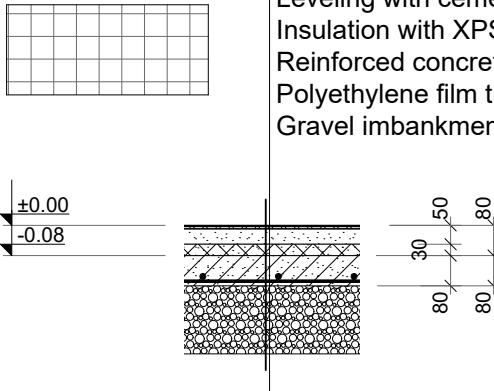

Basalt Floor  
Basalt tile 30 mm  
Cement-sand mortar  
Reinforced concrete slab, 8 cm  
Gravel imbankment

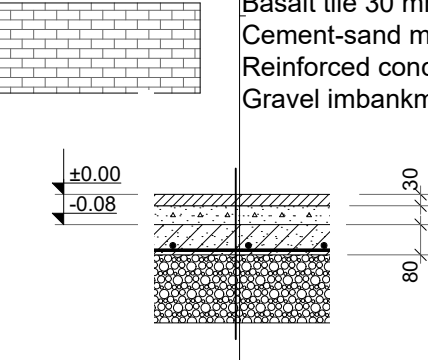

Ceiling Structure

Reinforced concrete slab  
Fiberglass insulation with foil, 10 cm  
Gypsum board (plastic) structure 12mm  
Gypsum board (plastic)12mm

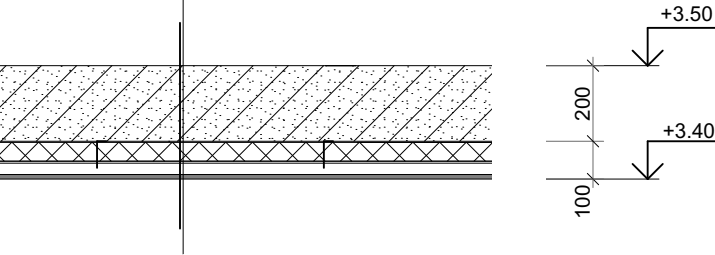

Remark:The plastic ceiling is arranged in the WC, in the kitchen, and on the terrace



## PVC Windows

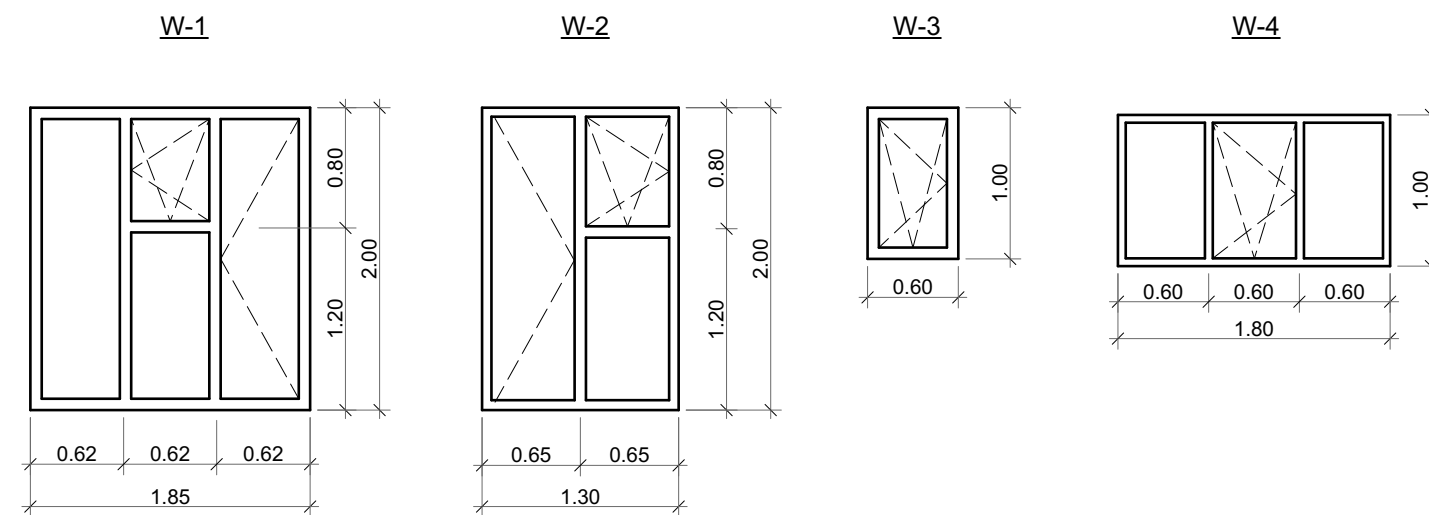

### Window Unit

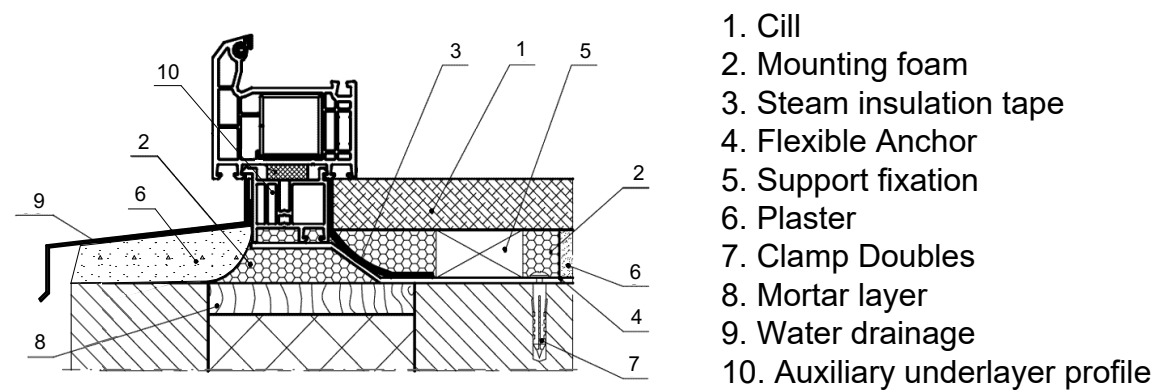

## Specification

მარკა Mark	რაოდენობა Quantity	სიგანე mm	სიმაღლე mm	m2	Σ m2
DIA-1	1	1500	2800	4.2	4.2
DM-1	5	1000	2800	2.8	14
DM-2	3	900	2800	2.52	7.56
DPVC-1	2	1500	2800	4.2	8.4
DPVC-2	12	1000	2800	2.8	33.6
DPVC-3	7	900	2800	2.52	17.64
DPVC-4	22	800	2800	2.24	49.28
W-1	21	1850	2000	3.7	77.7
W-2	7	1300	2000	2.6	18.2
W-3	5	600	1000	0.6	3
W-4	5	1800	1000	1.8	9

## Iso-aluminum Door

### Steel Door with Double Coating and Insulation

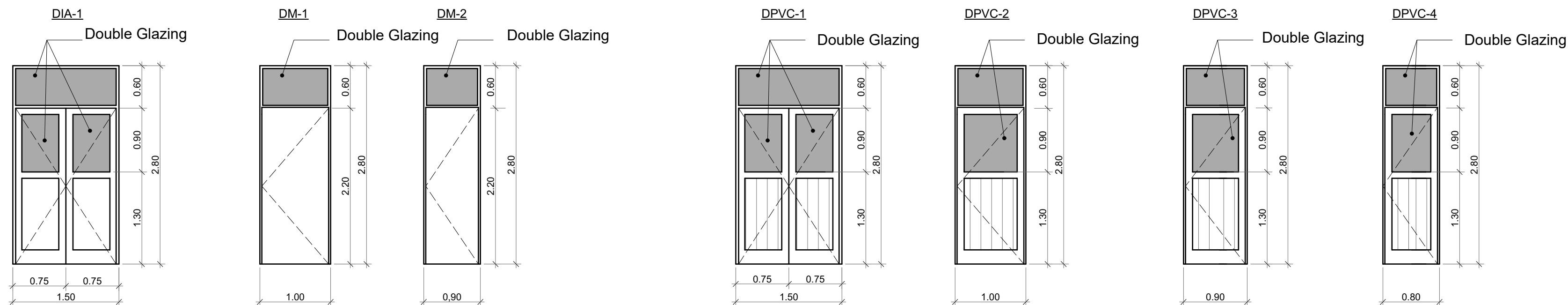

## PVC Internal Doors

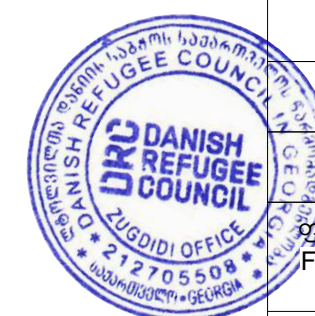



Steel Rails

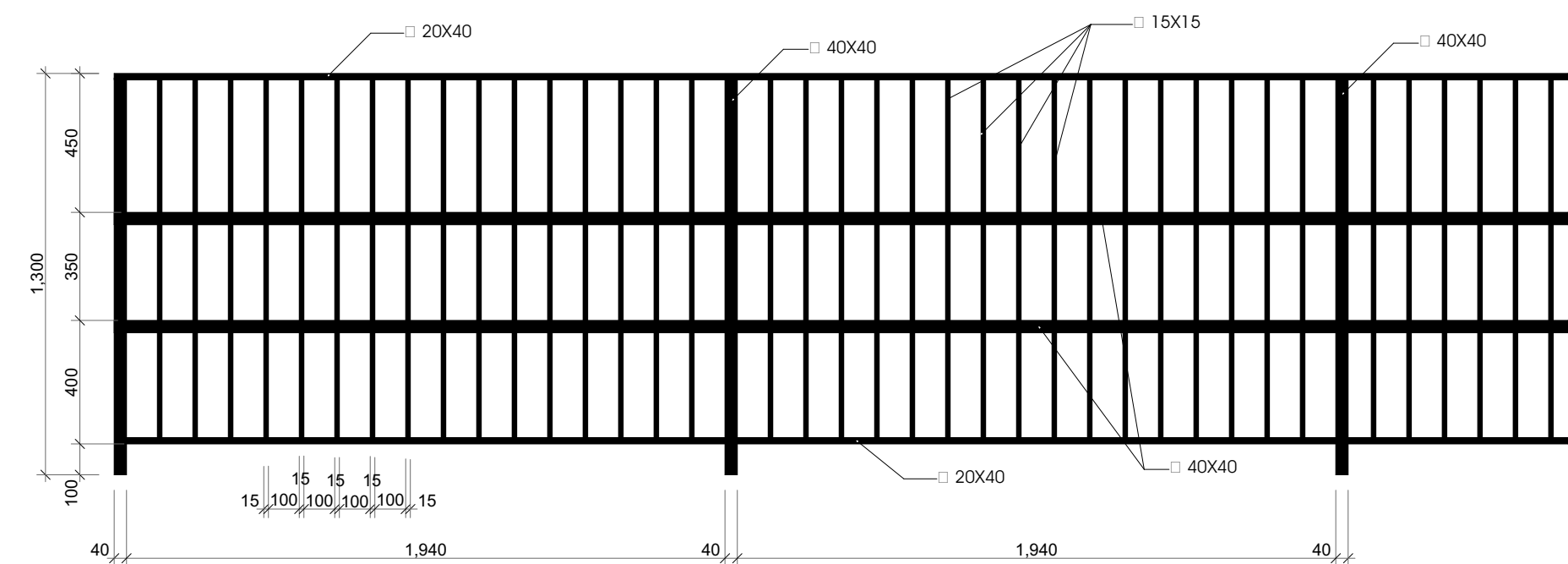

Steel Rails at the Staircase

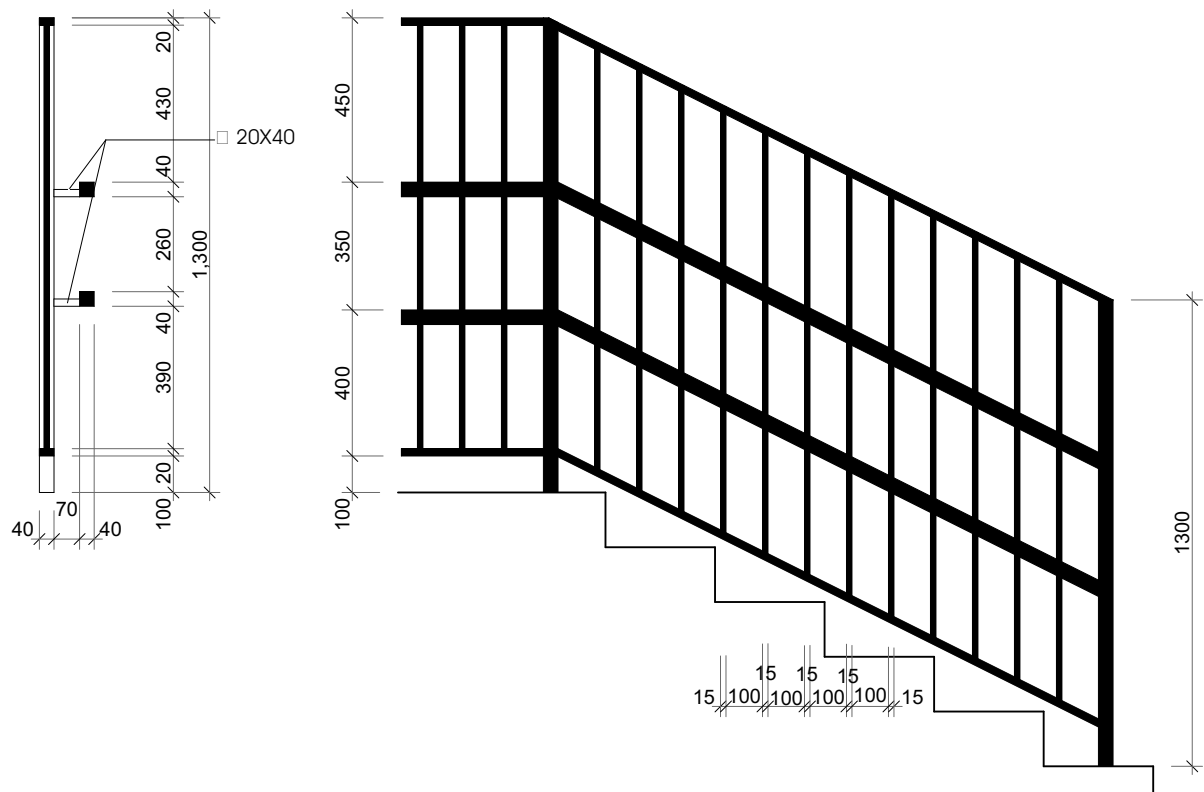

Senior Group Toilets for Boys and Girls (Rooms 13; 14)  
Employee changing-room (room 27) partitions

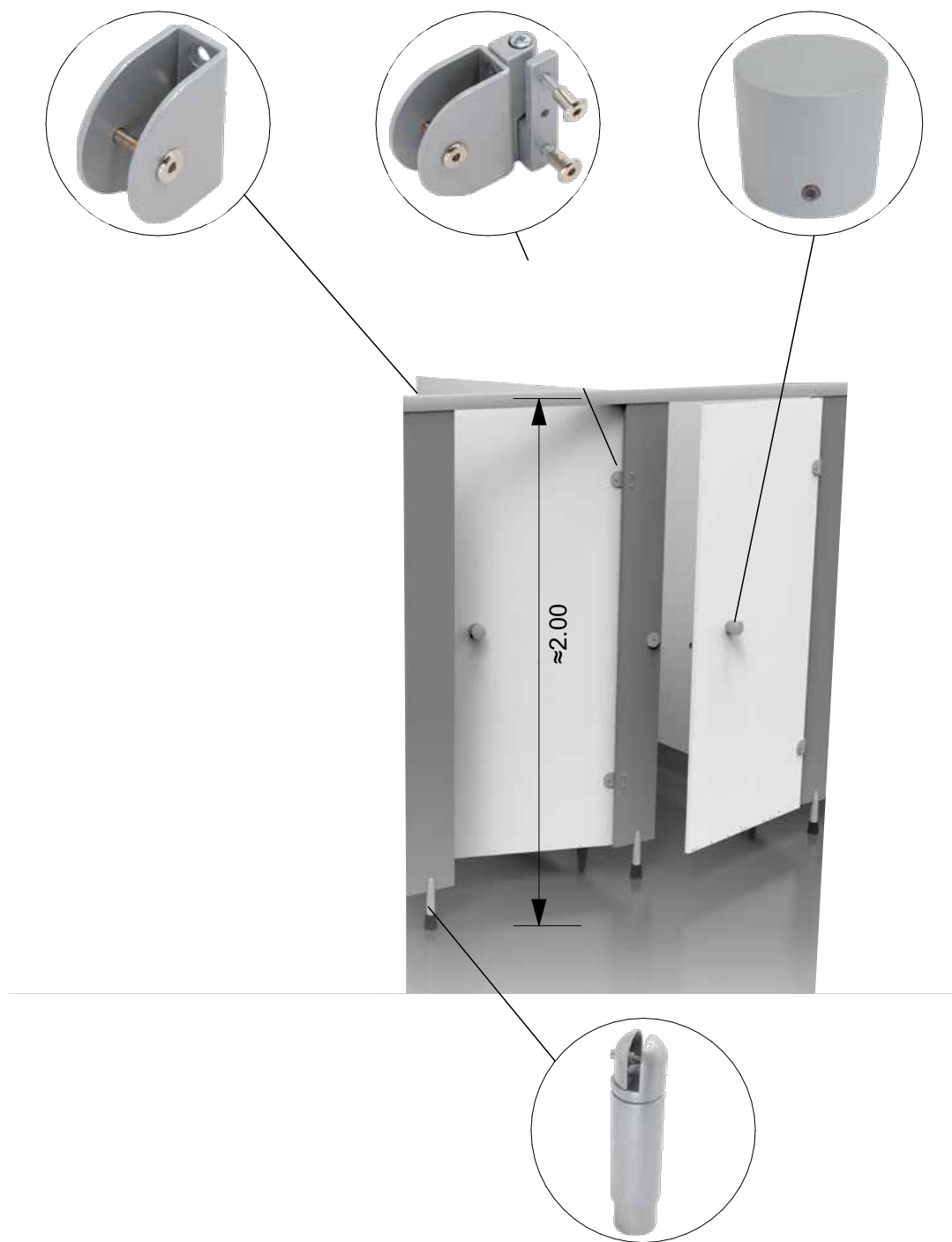

Steel Fixations

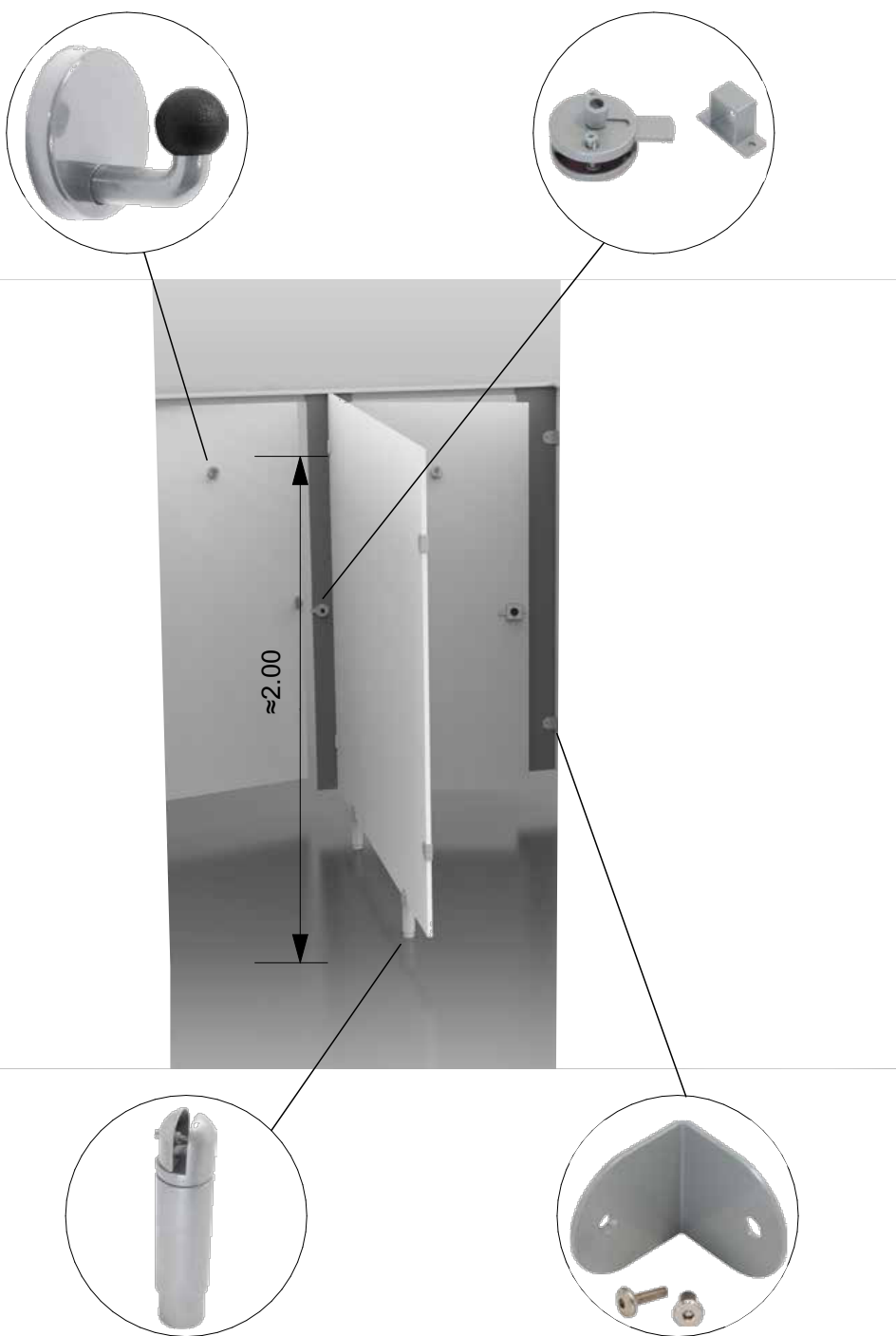
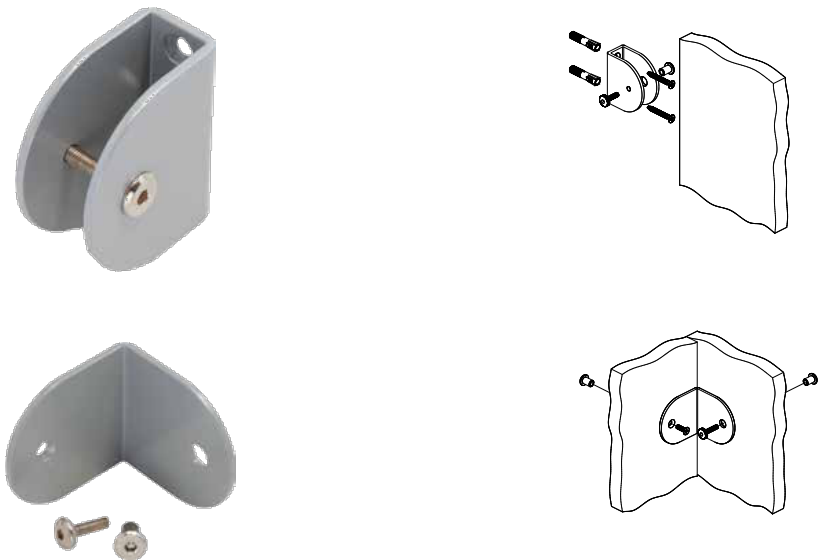

Steel supports



Steel Hinges

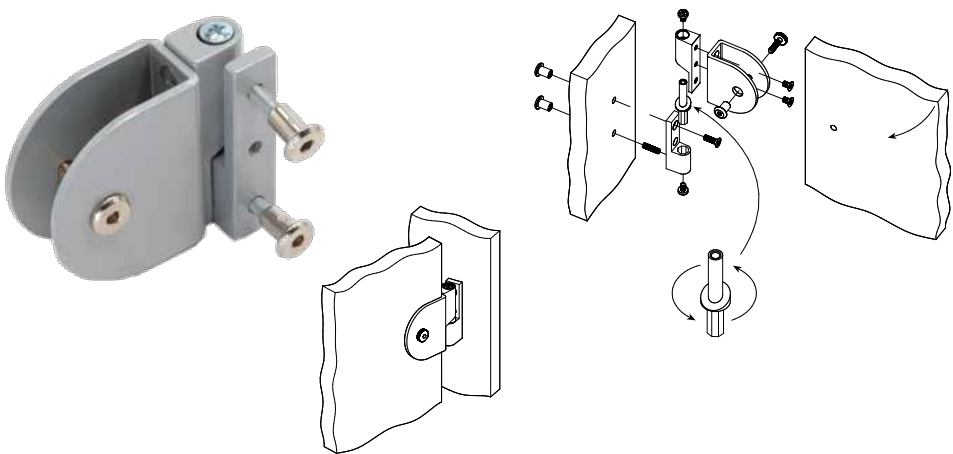

Steel Handles

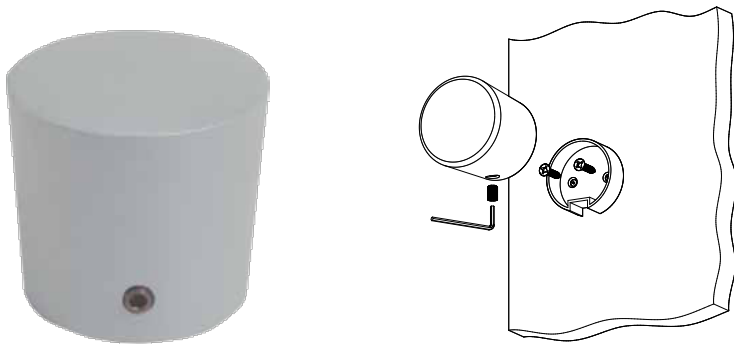

Folding screen between the toilet bowls  
in the WC of the younger group

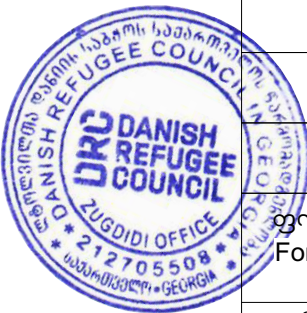
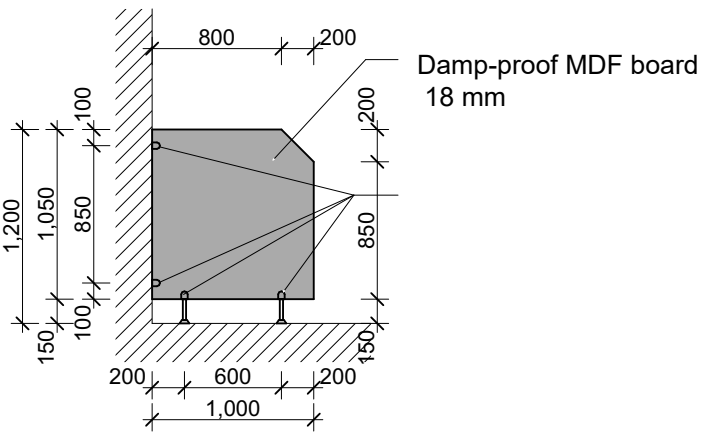



Project address:  
Georgia,  
Zugdidi

Stage:  
Architectural project

## Technological Plan of Rooms

3. Qantaria

გერგედავა  
A. Gergedava

०. फंक्श

Format A - 2

ფურცელი Page	ფურცლები Pages
24	28

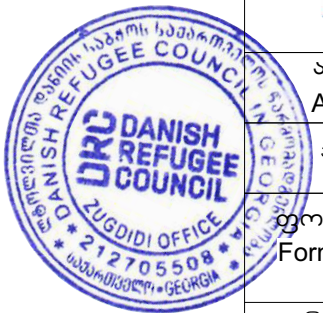
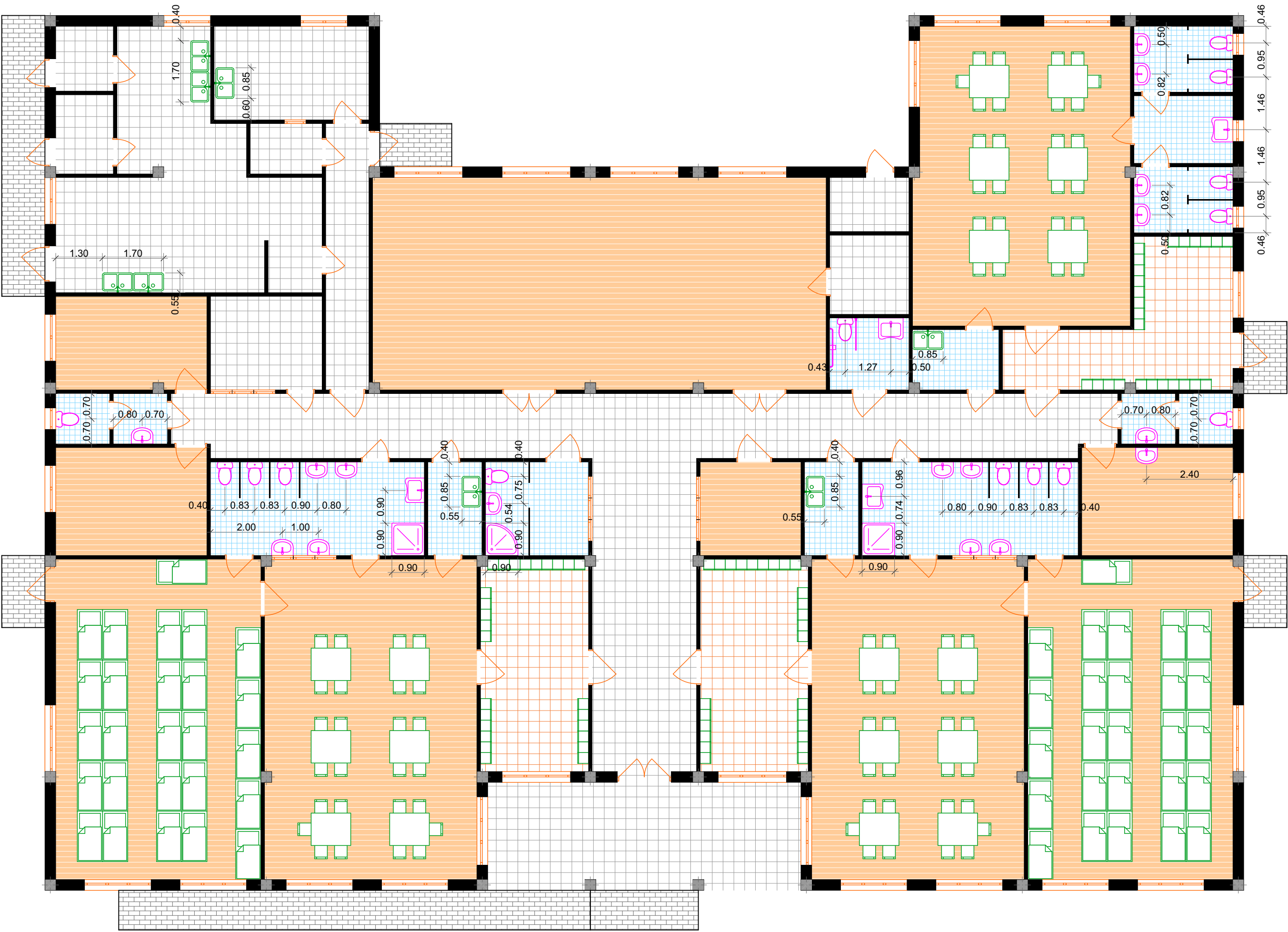



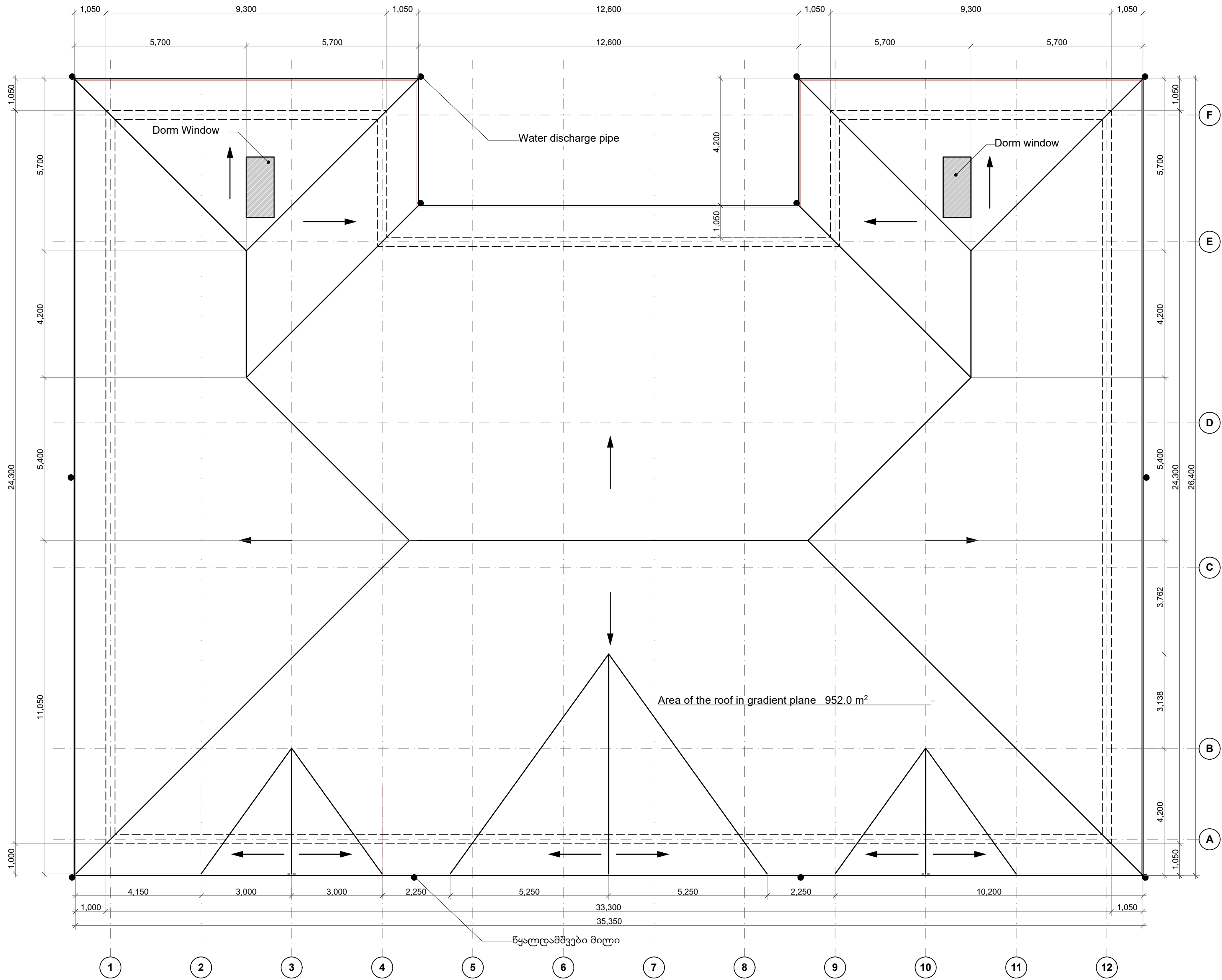



Construction Organizing Project

Explanatory Letter

The project for the organization of construction is elaborated in accordance with the decree of the Government of Georgia on the Rule on Issuance of a Construction Permit and the Conditions for Permit and the Construction Rules and Regulations SN. And sec. 3.01.01.-85 with regard to "Construction Organization". The project construction documents were the basis for the elaboration of the project organization.

Data on the construction site and the surrounding area

Construction is permitted after the issuing of the construction permit by Zugdidi Municipality City Hall.

Construction should be carried out following the technological cycles according to the calendar plan. It is inadmissible to deviate from approved design documentation solutions, and any changes made to the project must be agreed with the project authors. Construction of all temporary electrical equipment and grids for construction shall be carried out under applicable electrical technical regulations and regulations, as well as safety equipment regulations.

Construction conditions and site characterization.

Construction is envisaged in Zugdidi. The parameters of construction climatology for Khoni are as follows:

- Average annual temperature + 13.8 ° C
- Absolute maximum temperature + 40 ° C
- Absolute minimum temperature - 19 ° C
- Annual rainfall - 1723 mm
- Snow cover weight - 0.5 kPa
- Standard height of seasonal ground frost - 0 m
- Standard pressure of the wind is 0.3 kPa
- The direction of the prevailing wind is - East
- According to the seismic map, Khoni belongs to the 8-point seismic zone.

From the engineering-geological point of view, the construction site is in satisfactory condition; physical-geological hazards are not observed (landslides, hailstones, etc.).

Due to its location in the seismically active zone of the whole territory of Georgia, construction standards and regulations- "Sustainable Construction" (PN 01.01.09) apply throughout its territory to the design of residential, public and industrial buildings, as well as reconstruction, reinforcement, and restoration. Construction standards and regulations should be used in combination with other statutory documents in the field of construction.

During construction, the construction standards and requirements of regulations approved by the Minister of Economic Development of Georgia shall be observed.

The construction site is a square-shaped plot of land bounded by public zones to the north, namely to the street and the south, and by the adjacent land on all sides.

There are no buildings in the area.

The project envisages the placement of a kindergarten building by the main facade to the south public zone, with the main entrance being arranged on this side. The development and landscaping of the yard and arrangement of a playground and a harbor are planned as well as fencing.

The planning solution of the building includes the placement of three groups of kindergarten. Two of them will have a bedroom unit, while such a unit will not be for preschoolers; the girls 'and boys' toilets in this group are separated.

The building represented in the project is a one-story stone building the floor level of which is elevated by an average of 1.0 meters from the ground floor (including the walkway). The first floor level marker 0.00 corresponds to absolute marker 106.0. The floor height of the building is 3.4 meters from the floor to the ceiling. Exterior wall-filling is made of reinforced concrete with a small wall thickness of 30 cm thick.

The bearing structure of the building is a complex reinforced concrete frame, the structure made of reinforced concrete pillars, monolithic reinforced concrete girds, and reinforced concrete roofing slabs. Reinforced concrete pillars on the exterior walls can be concrete-casted in parallel with the construction of the wall.

Partitions are made of reinforced small pumice block of 10 cm thickness. The floors in the bathrooms are tiled, and the floors in the rooms are wooden (deck planks). Heat insulation of floor is made of XPS tiles, and ceiling insulation is made with fibered glass. Suspended ceilings in the kitchen and bathroom units are made of plastic and in the rooms are made of gypsum boards.

The bearing structure of the roof is wooden, and the roof slabs are made of painted metal tiles. The windows are made of double-glazed PVC profiles. Entrance doors are made of steel and iso-aluminum, in bathroom units from PVC and the doors in rooms are wooded (so-called MDF). The external stairs and staircase landings will be finished with basalt tiles.

The concrete walkway is arranged around the building. The building is provided with electricity, sewage and water supply networks, as well as an internal heating network, which will be connected to the main local external network.

Technical indicators for the area:

The total area of the territory - 4480.0 m2

Development area - 769.7 m2

Development density - 769.7 m2

Planting area - 3190.0 m2

The coefficient k 1 - 0.2

The coefficient k 2 - 0.2

Coefficient k 3 - 0.7

Technical specifications of the building:

Number of the floors of the building - 1

The volume of the building - 5313.0 m3

Including the surface of the land - 4158.0 m3

Underground - 1155.0 m3

Total area - 709.2 m2

Before construction, the construction site should be enclosed in a temporary fence within the cadastral border. The vertical planning project for conducting surface water to the street involves installing a bulkhead yard, for which a concrete boundary wall is provided, where the metal panel fence will then be installed. Ready concrete should be supplied with a concrete pump, which can be installed in the northern as well as the southern part of the yard. According to the decree of the Government of Georgia, taking into account the characteristics of the class of building, the building belongs to class 3.

Construction terms and stages

The duration of the construction shall be determined in accordance with the construction standards and regulations 1.04.03-85 taking into account the purpose, number of floors and materials used in the building. The seismic coefficient for civil buildings in 8-9 high seismic areas is assumed K = 1.15. The terms of construction were determined based on actual material-technical conditions and capabilities. Duration of construction was 12 months, including 1 month for preparatory work.

The preparatory work consists of two stages:

1. Preparatory work, which involves the disposal of garbage and solid waste, the installation of ballast imbankment, its ramming and the fencing of the construction site.
2. Marking off the building and removal and marking off the key axles. Preparatory work includes both organizational activities and external and internal construction works on the site.

The sequence of Construction Works:

- 1) Land and building sub-foundation works.
- 2) Arrangement of the building's foundation and basic construction system to zero.
- 3) Installation of the main bearing and non-bearing structures of the floor of the building.
- 4) Installation of the roof of the building
- 5) Installation of doors and windows.
- 6) Exterior finishing of the building.
- 7) Internal finishing of the building (in parallel, electrical and other engineering networks, in particular, water supply and sewerage, heating system installation).
- 8) Landscaping works.

Construction Site and Construction Safety Rules

Prior to the main construction works, the construction site and the surrounding area should be arranged. Construction site boundaries should usually fall within the cadastral boundaries of the land. After the ballast imbankment is laid, the construction site is fenced and the temporary buildings are arranged. Prior to the excavation works, the axes of the building should be marked off and removed from the perimeter of the building. Information banners perceived from public spaces should be placed on the construction site. Work on the construction site shall be organized in a way to ensure construction safety in accordance with Government Regulation # 6228.03.07, as well as the Construction Safety Rules and Construction Rules and Regulations III-4-80.

The construction safety rules apply to construction under the permit site preparatory works and defines the security requirements while implementing the following works the construction site: organizing, construction machinery, technical equipment and tools in operation, electric and gas-welding, loading-unloading, insulation, the land, the foundations, roofing works, underground works, concrete and reinforced concrete, installation, demolition, and other construction works.

All fire safety measures shall be complied with in accordance with the Construction Standards and Regulations 2.01.02-91 of the Fire-Safety Standards. Entrance to the construction site should be controlled and the possibility of unauthorized entry should be excluded. The enclosure in the public zone should be covered with a protective cover to ensure the safety of pedestrians. During darkness, the fencing should be equipped with signaling lamps or use materials or colors perceived in the dark. In the same manner, the area of demolishing of structures must be fenced.

A responsible person for adhering to safety rules should be assigned to the construction site. Workers and engineers must wear helmets, and special work must be performed using appropriate equipment. First aid facilities should be provided on the construction site. Materials, structures and other equipment should be stored and disposed of following the standards to allow them to fall, settle, slide and expand.

Dusty materials should be stored in storage areas. During loading and unloading operations precautions shall be taken to prevent their scattering and overflow. Harmful or explosive solvents should be stored in a tightly sealed container. Temporary structures should be provided on the south side of the building to keep up to the work hygienic conditions and proper organization of labor, which must be removed immediately before the completion of the site improvement works.

List of Covert Works Acts

Upon completion of the major construction work, before the start of the next stage of works which can cause its concealing, the covert works act should be prepared by the construction developer, following the site investigation before its completion.

List of the main construction and installation works, which should be followed by a covert works act:

- Marking off building axes.
- Accepting a trench arranged for foundations
- Arrangement of a reinforced concrete foundation
- Arrangement of reinforced concrete inserts and walls
- Examine the waterproofing of foundation, basement walls, and roofing
- Connecting walls to columns.
- Accepting development works.

During the works on the construction site, it is necessary to implement measures for the protection of nature and air pollution in accordance with the applicable legislative acts and normative documents. It is forbidden to cut perennial trees and plants in the construction zone without the permission of the Environment Protection Agency. It is prohibited to wash concrete or cement solution pipes in existing sewage manholes or to dump them with construction debris. If construction or reconstruction is expected to spread dust, the building should be covered with a curtain or work should be carried out indoors. When transporting loose construction debris, the surface must be soaked or covered with a protective coating after loading it into the car body. Before leaving the construction site, tires need to be cleaned to prevent contamination of city streets.

Recommended construction machinery-tools, vehicles

List of technical means

Excavator, with capacity of 0.2 m3

Road rammer

Lift crane

Auto-damper

Vehicle with body

Special motor vehicle with trailer

Portable compressor

An in-depth vibrator

Surface vibrator

Welding plant

Concrete mixer

Concrete pump with conveyor

Multipurpose electro-pneumatic unit

List of Works

Land works

Yard development

Various works

Ground removal, delivery of inert materials

Goods delivery

Transportation of reinforced concrete and other large materials

Air supply

Concrete works

Concrete mortars

Welding Works

Mortar preparation

Concrete works

Construction and Special Works

<div></div>	
Danish Refugee Council	
<div><div>Kindergarten</div><div>Laghidze street, Zugdidi</div></div>	
<div><div>Project address:</div><div>Georgia, Zugdidi</div></div>	
<div><div>Stage:</div><div>Architectural project</div></div>	
<div><div>Construction organization plan</div></div>	
<div><div>ბ. ჭანთარია</div><div>B. Qantaria</div></div>	
<div><div>ა. გერგელავა</div><div>A. Gergedava</div></div>	
<div><div>ფორმატი</div><div>Format</div></div> <div>A - 2</div>	
<div><div>ფურცელი</div><div>Page</div></div> <div>26</div>	<div><div>ფურცლები</div><div>Pages</div></div> <div>28</div>

Note: it is possible to use modern equipment with the same parameters, given the data of the existing technical facilities.

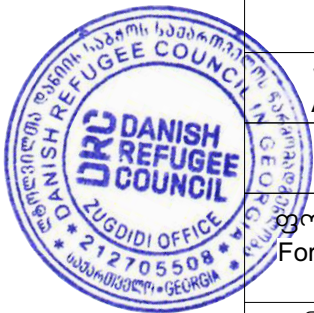



Constuction General Plan

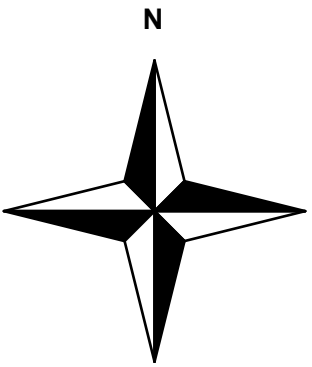
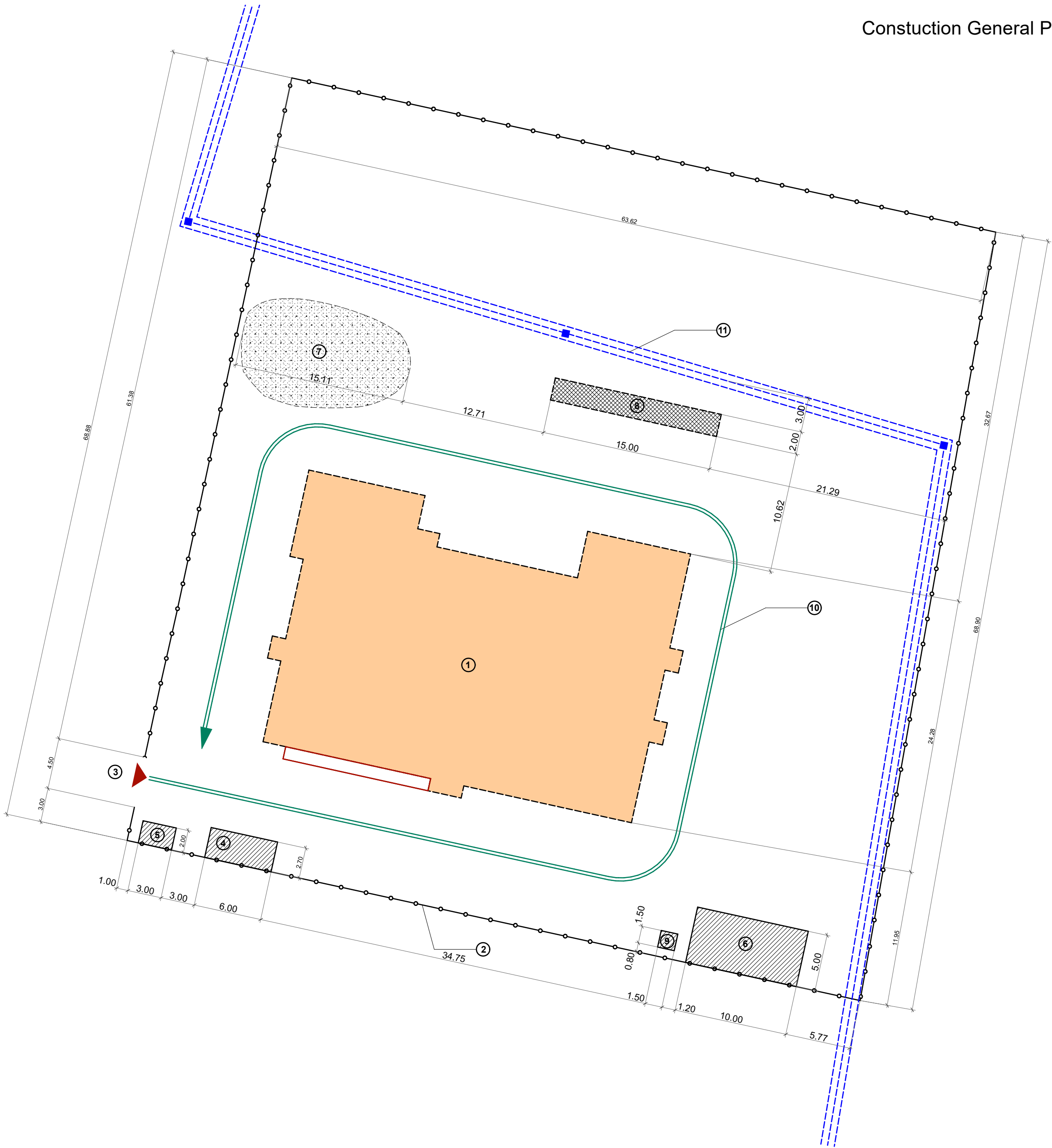

Legend:

- 1. Project Building
- 2. Temporary fence
- 3. Entrance
- 4. Staff room
- 5. Security room
- 6. Closed Warehouse
- 7. Open warehouse for inert materials
- 8. Warehouse for reinforcement
- 9. Temporary bio-toilet
- 10. Vehicle path
- 11. Power line





Time Schedule of the Construction

	12 months																																																																																																																																																																																																																																																																																																																																																																																																																																																																																																																																																																																																																																																																																																																																																																																																																																																																																																																																																																																																																																																																																																																																																																																																																																																																																																																																																																																																																																																																																																																																																																																																																																																																																																																																																																																																																																																																																																																																																																																																																																																																																																																			

პროექტის  
მისამართი:  
  
საქართველო,  
ზუგდიდი  
  
Project address:  
  
Georgia,  
Zugdidi

ეტაპი:    მუშა  
              პროექტი  
Stage:  
Architectural project

